



USER MANUAL

SCALING HAMMER

MODELS : FS-2A, -2A-1F



FS-2A



FS-2A-1F

OPTIONAL PART



Tungsten Carbide Tipped Piston is available at request.

SPECIFICATIONS

Model	Number of Cylinder	Blows	Piston Diameter		Stroke (about)		Angle Height (about)		Overall Length (about)		Mass (about)		Air Consumption Under Load (about)		Air Inlet Thread Size	Air Hose Size	
		Hz	mm	in	mm	in	mm	in	mm	in	kg	lb	Nm ³ /min	NI ³ /min	PT or NPT	mm	in
FS-2A	1	133	30	1 ³ / ₁₆	16	5/8	94	3 ¹¹ / ₁₆	510	20 ⁹ / ₆₄	2.5	5.5	0.25	8.8	3/8"	9.5	3/8
FS-2A-1F	1	133	30	1 ³ / ₁₆	16	5/8	94	3 ¹¹ / ₁₆	537	21 ⁹ / ₆₄	2.5	5.5	0.25	8.8	3/8"	9.5	3/8

The performance figures are at 0.63 MPa (6.3 bar).



Refer to "The Instructions and Warning for Safety Use" enclosed in each tool box.

FUJI AIR TOOLS CO., LTD.

2-1-14 Kamiji, Higashinari-ku, Osaka, 537-0003 Japan

Tel : (06) 6972-2335

Fax : (06) 6972-2250

BOLT & NUT SETTERS
SCREW DRIVERS

ABRASIVE TOOLS

DRILLS · TAPPERS

PERCUSSION TOOLS

AIR MOTORS & OTHERS

OTHER PRODUCTS



PARTS LIST MODEL: FS-2A, -2A-1F

EXPLODED VIEW

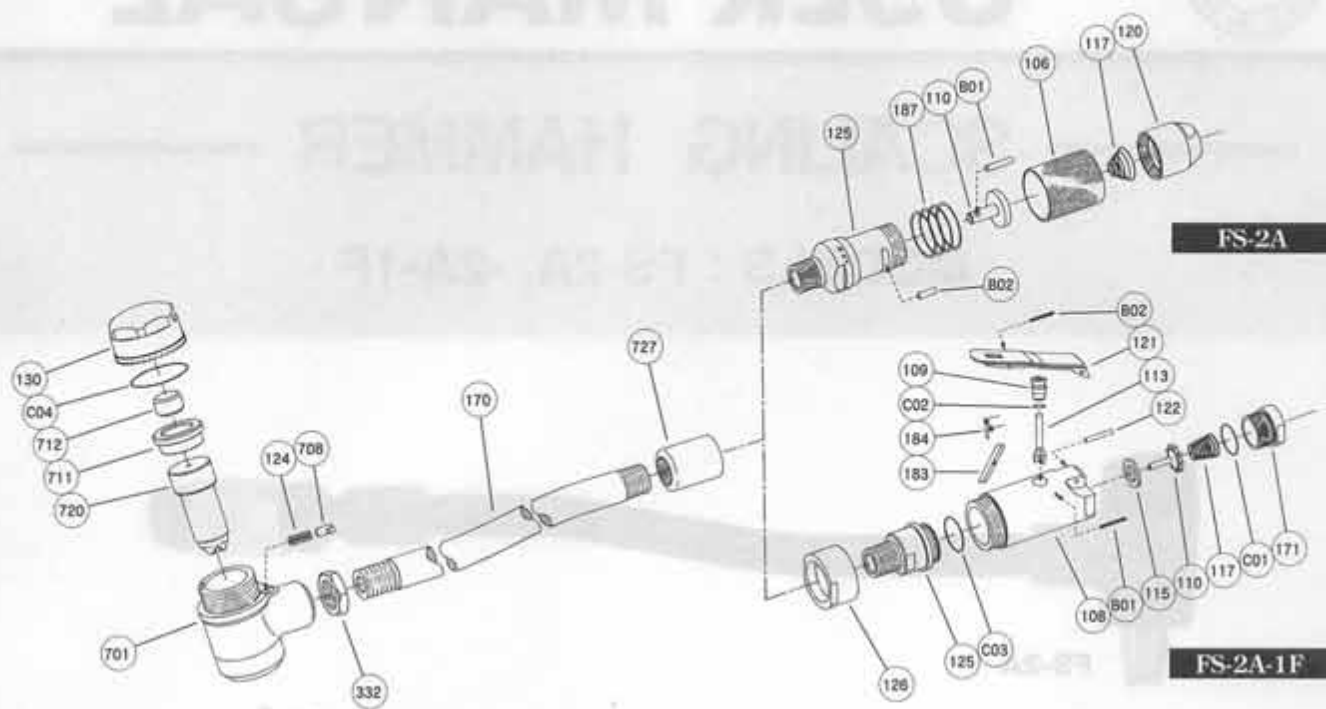

PARTS LIST

Index No.	Parts No.	Parts Name	Qt.
FS-2A			
CP No.	S-012004-01	Throttle Valve Stem CP	
106	G-082106-01	Throttle Valve Handle	1
110	G-044110-00	Throttle Valve	1
117	G-044117-00	Throttle Valve Spring	1
120	G-044120-A	Throttle Valve Cover <PT>	1
120	G-044120-N	Throttle Valve Cover <NPT>	1
125	S-012125-01	Throttle Valve Stem	1
187	A-011187-01	Throttle Valve Handle Spring	1
B01	NR-420	Needle Roller	1
B02	NR-413	Needle Roller	1
FS-2A-1F			
CP No.	Y-020003-00	Throttle Valve Body CP	
108	Y-020108-00	Throttle Valve Body	1
109	Y-020109-00	Throttle Valve Bushing	1
110	Y-020110-00	Throttle Valve	1
113	Y-020113-00	Throttle Valve Rod	1
115	Y-020115-00	Throttle Valve Sheet	1
117	Y-020117-00	Throttle Valve Spring	1
121	G-144121-02	Throttle Valve Lever	1
122	H-001122-00	Throttle Valve Lever Pin	1
125	Y-020125-00	Throttle Valve Stem	1
126	Y-020126-00	Throttle Valve Stem Nut	1
171	Y-020171-00	Inlet Joint <PT>	1

Index No.	Parts No.	Parts Name	Qt.
171	Y-020171-01	Inlet Joint <NPT>	1
183	G-144183-02	Lock Key	1
184	G-144184-00	Lock Spring	1
B01	SP-220	Spring Pin	1
B02	SP-218	Spring Pin	1
C01	O-S22	"O" Ring	1
C02	O-S8	"O" Ring	1
C03	O-S25	"O" Ring	1
FS-2A FS-2A-1F			
124	H-042124-00	Knock Spring	1
130	H-042130-00	Cap	1
170	H-021170-00	Pipe	1
332	H-021332-00	Lock Nut	1
701	H-042701-00	Cylinder	1
708	H-042708-00	Locking Clutch	1
711	H-021711-00	Cylinder Cover	1
712	H-042712-00	Damper	1
720	H-042720-00	Piston	1
727	H-021727-00	Socket Joint	1
C04	O-S40	"O" Ring	1
OPTIONAL PART			
720	H-042720-C	Piston (With Tungsten Carbide Tip)	1

CP No. denotes the assembled parts comprising of more than 1 pc. of parts.
The related parts are shown in the thick frame.

Specify parts number and quantity in ordering.