



USER MANUAL

DRILLS

MODELS : FRD-16Z, (C) SERIES



FRD-16Z-1



FRD-16Z-2, -3

SPECIFICATIONS

Model	Drilling Capacity		Stall Torque			Rotational Frequency	Type and Size of Spindle		Chuck Capacity	Distance from Center to Side			Overall Length		Mass		Max. Air Consumption	
	mm	in	N·m	kgf·m	ft·lb	min ⁻¹	Thread	Taper	mm	mm	in	mm	in	kg	lb	m ³ /min	ft ³ /min	
FRD-16Z-1(C)	16	5/8	34.3	3.5	25.3	800	5/8-16	—	16	34	1 11/32	364	14 21/64	3.7	8.1	1.2	42.4	
FRD-16Z-2(C)	16	5/8	34.3	3.5	25.3	800	—	M.T.#1	—	34	1 11/32	372	14 41/64	3.4	7.5	1.2	42.4	
FRD-16Z-3(C)	16	5/8	34.3	3.5	25.3	800	—	M.T.#2	—	34	1 11/32	385	15 5/32	3.6	7.9	1.2	42.4	

Air Hose Size : 12.7mm (1/2")
Air Inlet Thread Size : PT or NPT 3/8"

The performance figures are at 0.63MPa (6.3bar).

Refer to "The Instructions and Warning for Safety Use" enclosed in each tool box.

FUJI AIR TOOLS CO., LTD.

2-1-14 Kamiji, Higashinanku, Osaka 537-0003, Japan

Tel : (06) 6972-2335

Fax : (06) 6972-2250

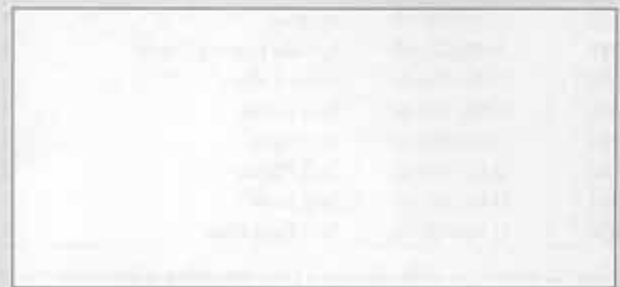

PARTS LIST MODEL: FRD-16Z, (C) SERIES

EXPLODED VIEW

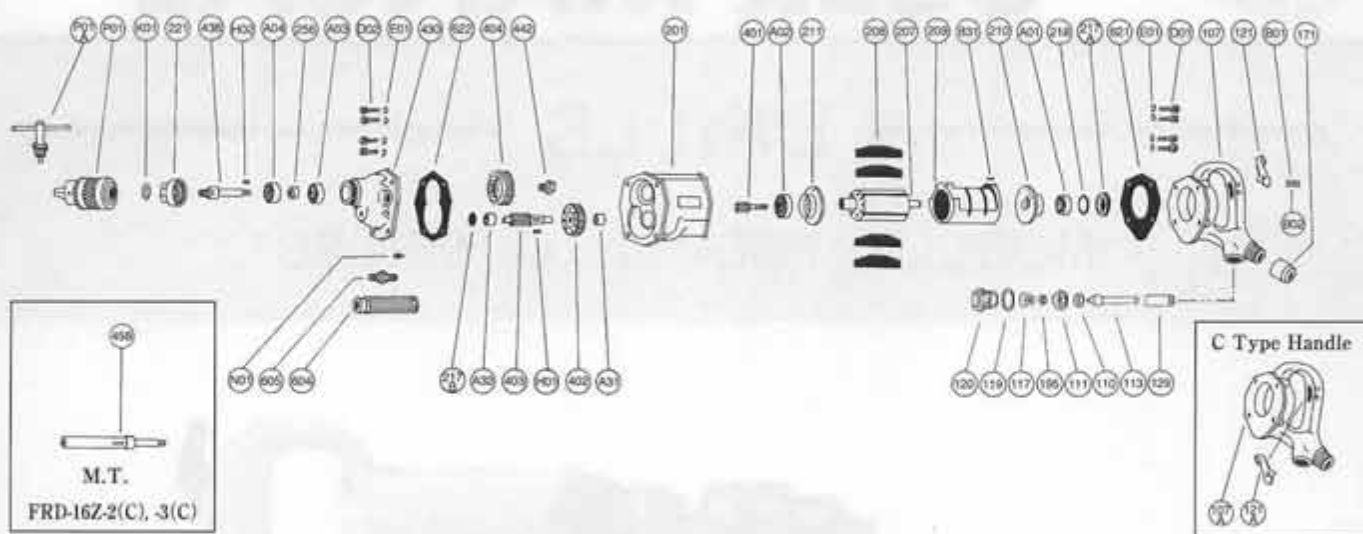

FRD-16Z-1

PARTS LIST

Index No.	Parts No.	Parts Name	Qt.	Index No.	Parts No.	Parts Name	Qt.
FRD-16Z-1, ~-3, (C)							
Ass'y No.	D-005002-00	Handle Ass'y (PT)		438	D-007438-01	Spindle	1
Ass'y No.	D-005002-03	Handle Ass'y (NPT)		442	D-005442-00	Spindle Screw	1
107	D-005002-50	Handle	1	604	A-025604-02	Dead Handle	1
(129)	H-006129-00	Throttle Valve Rod Bushing	1	605	A-025605-00	Dead Handle Joint	1
117	D-005117-00	Throttle Valve Spring	1	621	D-005621-02	Packing (A)	1
119	W-080119-00	T.V. Cover Packing	1	622	D-005622-00	Packing (B)	1
120	D-005120-00	Throttle Valve Cover	1	A01	BB-6200	Ball Bearing	1
121	W-014121-01	Throttle Valve Lever	1	A02	BB-6002	Ball Bearing	1
171	D-005171-00	Inlet Joint (PT)	1	A03	BB-6202	Ball Bearing	1
171	D-005171-01	Inlet Joint (NPT)	1	A04	BB-6202	Ball Bearing	1
B01	NR-419	Needle Roller	1	A31	NB-SC66	Needle Bearing	1
B02	NR-422	Needle Roller	1	A32	NB-SC66	Needle Bearing	1
Ass'y No.	W-080008-01	Throttle Valve Rod Ass'y		D01	CS-625	Cap Screw	4
110	W-080110-01	Throttle Valve	1	D02	CS-620	Cap Screw	4
111	W-080111-00	Throttle Valve Washer	1	E01	PW-6	Plain Washer	8
113	W-080113-01	Throttle Valve Rod	1	H01	K-3310	Key	1
195	W-080195-00	Sub Throttle Valve	1	H02	K-3310	Key	1
201	D-005201-00	Housing	1	K01	OS-ZF5	Oil Seal	1
207	D-005207-00	Rotor	1	N01	GN-6	Grease Nipple	1
208	D-005208-00	Rotor Blade	4	P01	DCK-16	Drill Chuck	1
209	G-022209-00	Cylinder	1	(P01A)	DCK-16H	Drill Chuck Handle	1
(B31)	SP-314	Spring Pin	1	Parts for C Type Handle			
210	G-022210-00	Cylinder Upper Plate	1	Ass'y No.	D-005002-01	Handle Ass'y (PT)	
211	D-005211-00	Cylinder Lower Plate	1	Ass'y No.	D-005002-02	Handle Ass'y (NPT)	
217A	G-044217-A	Bearing Cover	1	107A	D-005002-51	Handle	1
217B	G-005217-00	Bearing Cover	1	(129)	H-006129-00	Throttle Valve Rod Bushing	1
218	G-044218-00	Packing	1	121A	W-015121-A	Throttle Valve Lever	1
221	D-005221-00	Spindle Bearing Cover	1	Parts for FRD-16Z-2 & 2C			
256	D-005256-00	Space Collar	1	FRD-16Z-2 & 2C are equipped with Index No. 458 MT No.1 Socket. Index Nos. 438 Spindle and P01 Drill Chuck are not furnished to these models.			
401	D-007401-00	No.1 Pinion	1	458	D-005458-00	MT, No.1 Socket	1
402	D-007402-00	No.1 Gear	1	Parts for FRD-16Z-3 & 3C			
403	D-007403-00	No.2 Pinion	1	FRD-16Z-3 & 3C are equipped with Index No. 458 MT No.2 Socket. Index Nos. 438 Spindle and P01 Drill Chuck are not furnished to these models.			
404	D-007404-00	No.2 Gear	1	458	D-007458-00	MT, No.2 Socket	1
430	D-005430-00	No.1 Gear Case	1				

□ Ass'y No. denotes No. of the assembled parts comprising of more than 1 pc. of parts. The related parts are shown in the thick frame.

□ Index Nos. 107, 209, and P01 are supplied together with parts shown in ().
 □ Specify parts number and quantity in ordering.