

## EXPLODED VIEW

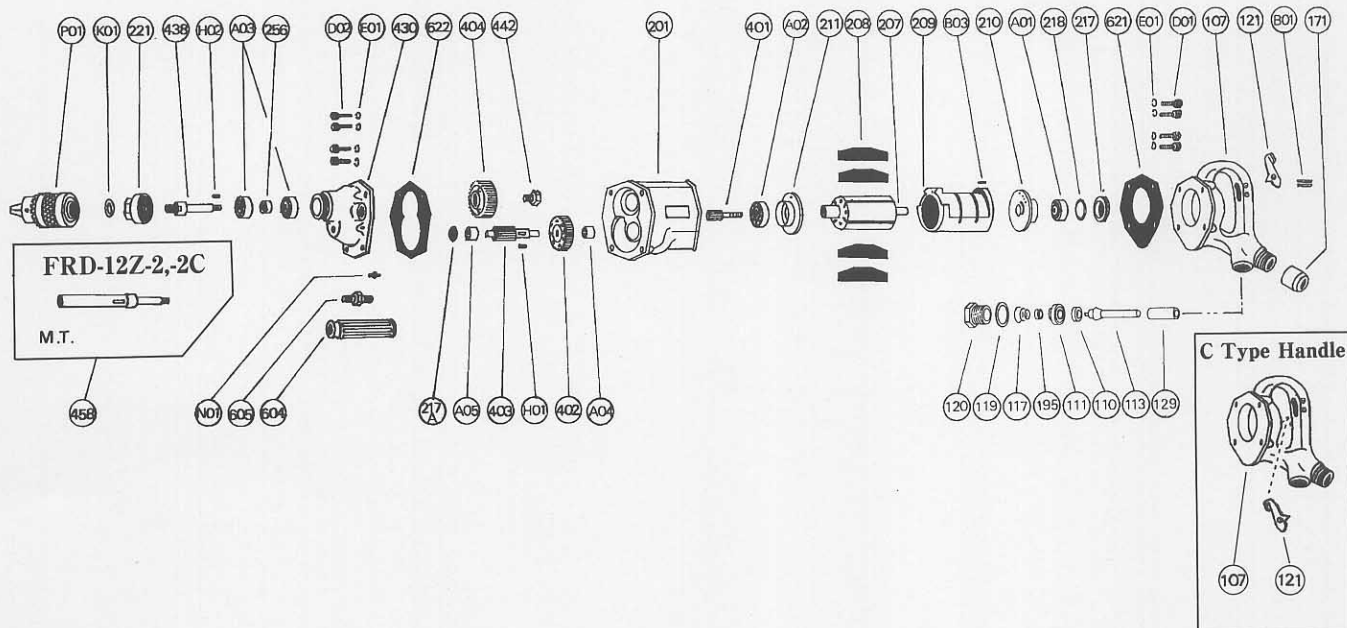

## PARTS LIST

Index No.	Parts No.	Parts Name	Qt.
<b>CP No.</b>	<b>D-005002-00</b>	<b>Handle CP</b>	
107	D-005002-50	Handle	1
(129)	H-006129-00	Throttle Valve Rod Bushing	1
117	D-005117-00	Throttle Valve Spring	1
119	W-080119-00	T.V. Cover Packing	1
120	D-005120-00	Throttle Valve Cover	1
121	W-014121-01	Throttle Valve Lever	1
171	D-005171-00	Inlet Joint <PT>	1
171	D-005171-01	Inlet Joint <NPT>	1
B01	NR-419	Needle Roller	1
B02	NR-422	Needle Roller	1
<b>CP No.</b>	<b>W-080008-01</b>	<b>Throttle Valve Rod CP</b>	
110	W-080110-01	Throttle Valve	1
111	W-080111-00	Throttle Valve Washer	1
113	W-080113-01	Throttle Valve Rod	1
195	W-080195-00	Sub Throttle Valve	1
201	D-005201-00	Housing	1
207	D-005207-00	Rotor	1
208	D-005208-00	Rotor Blade	4
209	G-022209-00	Cylinder	1
(B03)	SP-314	Spring Pin	1
210	G-022210-00	Cylinder Upper Plate	1
211	D-005211-00	Cylinder Lower Plate	1
217	G-044217-A	Bearing Cover	1
217A	D-005217-00	Bearing Cover	1
218	G-044218-00	Packing	1
221	D-005221-00	Spindle Bearing Cover	1
256	D-005256-00	Space Collar	1
401	D-005401-00	No.1 Pinion	1
402	D-005402-00	No.1 Gear	1

Index No.	Parts No.	Parts Name	Qt.
403	D-005403-00	No.2 Pinion	1
404	D-005404-00	No.2 Gear	1
430	D-005430-00	No.1 Gear Case	1
438	D-005438-A	Spindle	1
442	D-005442-00	Spindle Screw	1
604	A-025604-02	Dead Handle	1
605	A-025605-00	Dead Handle Joint	1
621	D-005621-02	Packing <A>	1
622	D-005622-00	Packing <B>	1
A01	BB-6200	Ball Bearing	1
A02	BB-6002	Ball Bearing	1
A03	BB-6202	Ball Bearing	2
A04	NB-SC66	Needle Bearing	1
A05	NB-SC66	Needle Bearing	1
D01	CS-625	Cap Screw	4
D02	CS-620	Cap Screw	4
E01	PW-6	Plain Washer	8
H01	K-3310	Key	1
H02	K-3310	Key	1
K01	OS-ZF5	Oil Seal	1
N01	GN-6	Grease Nipple	1
P01	DCK-13	Drill Chuck	1
<b>Parts for C Type Handle</b>			
107	D-005002-51	Handle	1
121	W-015121-A	Throttle Valve Lever	1
<b>Parts for FRD-12Z-2 &amp; 2C</b>			
FRD-12Z-2 & 2C are equipped with #458 MT No.1 Socket. #438 Spindle and #P01 Drill Chuck are not furnished to these models.			
458	D-005458-00	MT. No.1 Socket	1

CP No. denotes the assembled parts comprising of more than 1 pc. of parts.  
The related parts are shown in the thick frame.

#107 and 209 are supplied together with parts shown in ( ).

Specify parts number and quantity in ordering.

MANUFACTURER:  
**FUJI AIR TOOLS CO., LTD.**

1-14, Kamiji 2-chome, Higashinari-ku, Osaka 537, Japan  
Tel. : (06) 972-2335 (Overseas Dept) Fax : (06) 972-2250