



USER MANUAL

BABY ANGLE DRILLS

MODELS : FCD-6B-1, -1F



FCD-6B-1

Snake Drill for FCD-6B

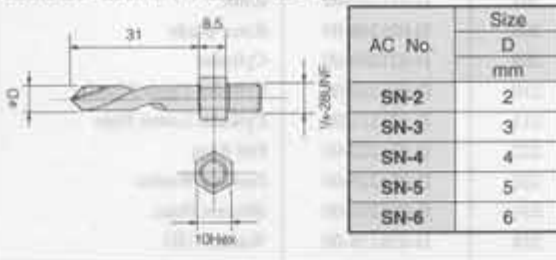

LOCKING LEVER HANDLE TYPE



FCD-6B-1F

SPECIFICATIONS

| Model | Drilling Capacity (about) | | Stall Torque (about) | | | Free Speed (about) | Size of Spindle Tapped Part | Side to Center (about) | | Overall Length (about) | | Weight (about) | | Air Consumption at Max. Output (about) | | Air Hose Size | |
|-----------|---------------------------|-----|----------------------|--------|--------|--------------------|-----------------------------|------------------------|-----|------------------------|--------|----------------|-----|--|----------------------|---------------|-----|
| | mm | in | N·m | kgf·cm | ft·lbs | rpm | in | mm | in | mm | in | kg | lb | Nm ³ /min | ft ³ /min | mm | in |
| FCD-6B-1 | 6 | 1/4 | 2.5 | 25 | 1.8 | 2,500 | 1/4-28 UNF | 9.5 | 3/8 | 222 | 8 7/64 | 0.6 | 1.3 | 0.28 | 9.8 | 6.3 | 1/4 |
| FCD-6B-1F | 6 | 1/4 | 2.5 | 25 | 1.8 | 2,500 | 1/4-28 UNF | 9.5 | 3/8 | 222 | 8 7/64 | 0.6 | 1.3 | 0.28 | 9.8 | 6.3 | 1/4 |

1/4" air inlet thread size. 6.3mm (1/4") air hose size.

The performance figures are at 620kPa (6.3 bar).

Refer to instructions and warning for safety use enclosed in each tool box.

FUJI AIR TOOLS CO., LTD.

1-14, Kamiji 2-chome, Higashinari-ku, Osaka, 537 Japan
 Tel : (06) 972-2335
 Fax : (06) 972-2250

BOLT & NUT SETTERS
SCREW DRIVERS

ABRASIVE TOOLS

DRILLS · TAPPERS

PERCUSSION TOOLS

AIR MOTORS & OTHERS

OTHER PRODUCTS

PARTS LIST MODEL: FCD-6B-1,-1F

EXPLODED VIEW

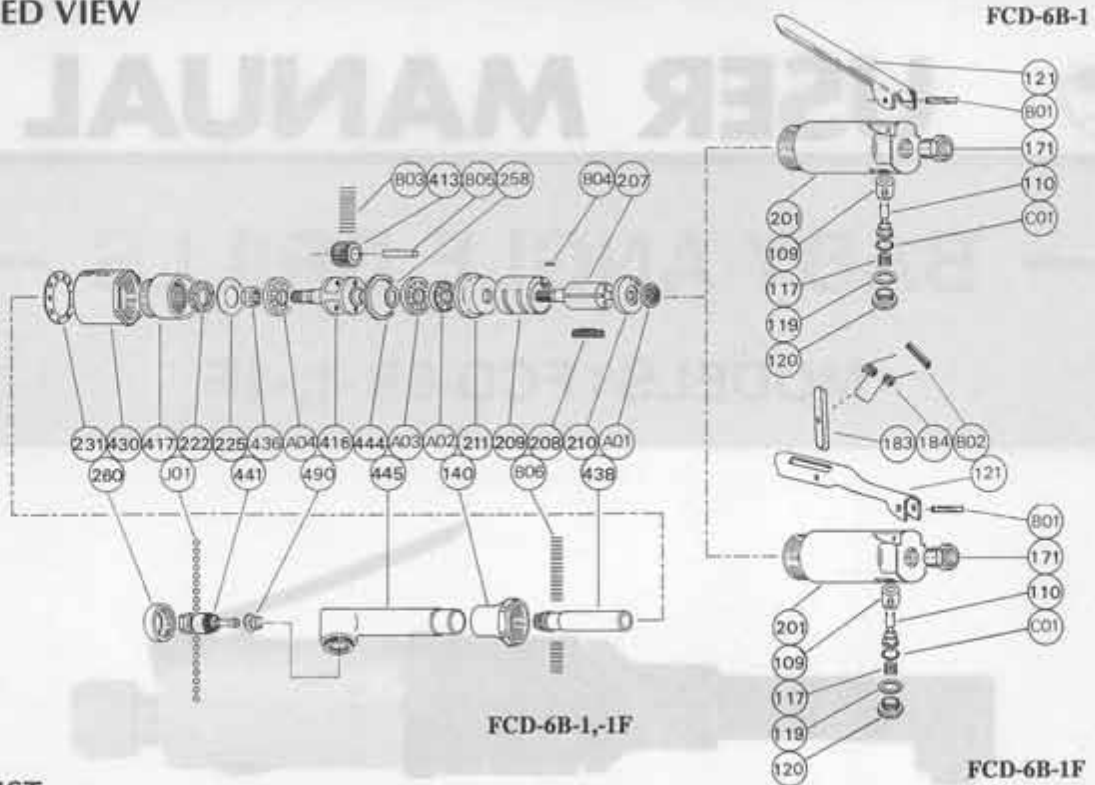

PARTS LIST

| Index No. | Parts No. | Parts Name | Qt. | Index No. | Parts No. | Parts Name | Qt. |
|------------------|--------------------|------------------------|-----|---------------------|-------------|------------------------|-----|
| FCD-6B-1 | | | | FCD-6B-1,-1F | | | |
| CP No. | D-021006-00 | Housing CP | | 140 | D-021140-00 | Cup Nut | 1 |
| 201 | D-021006-50 | Housing | 1 | 207 | D-021207-00 | Rotor | 1 |
| (109) | D-021109-00 | Throttle Valve Bushing | 1 | 208 | D-021208-00 | Rotor Blade | 4 |
| 110 | D-021110-A | Throttle Valve | 1 | 209 | D-021209-00 | Cylinder | 1 |
| 117 | D-021117-00 | Throttle Valve Spring | 1 | 210 | D-021210-00 | Cylinder Upper Plate | 1 |
| 119 | D-021119-00 | T.V. Cover Packing | 1 | 211 | D-021211-00 | Cylinder Lower Plate | 1 |
| 120 | D-021120-00 | Throttle Valve Cover | 1 | 222 | D-021222-00 | Felt Ring | 1 |
| 121 | D-021121-A | Throttle Valve Lever | 1 | 225 | D-021225-00 | Packing Washer | 1 |
| 171 | IB-202000 | Inlet Bushing (PT) | 1 | 231 | D-021231-00 | Silencer Plate | 1 |
| 171 | IB-202N00 | Inlet Bushing (NPT) | 1 | 258 | D-058258-00 | Washer (B) | 1 |
| B01 | SP-320 | Spring Pin | 1 | 260 | D-022260-00 | Bearing Case | 1 |
| C01 | O-P3 | "O" Ring | 1 | 413 | D-021413-00 | NO.1 Planet Gear | 2 |
| FCD-6B-1F | | | | (B03) | NR-19.5 | Needle Roller | 24 |
| CP No. | D-021006-02 | Housing CP | | 416 | D-021416-00 | NO.1 Planet Gear Frame | 1 |
| 201 | D-021006-50 | Housing | 1 | 417 | D-021417-00 | NO.1 Internal Gear | 1 |
| (109) | D-021109-00 | Throttle Valve Bushing | 1 | 430 | D-022430-00 | NO.1 Gear Case | 1 |
| 110 | D-021110-A | Throttle Valve | 1 | 436 | D-021436-00 | Bearing Holder | 1 |
| 117 | D-021117-00 | Throttle Valve Spring | 1 | 438 | D-021438-00 | Spindle | 1 |
| 119 | D-021119-00 | T.V. Cover Packing | 1 | 441 | D-022441-00 | Spindle (B) | 1 |
| 120 | D-021120-00 | Throttle Valve Cover | 1 | 444 | D-021444-00 | Internal Gear Washer | 1 |
| 171 | IB-202000 | Inlet Bushing (PT) | 1 | 445 | D-022445-00 | Spindle Case | 1 |
| 171 | IB-202N00 | Inlet Bushing (NPT) | 1 | 490 | D-021490-00 | Spindle Bushing | 1 |
| B01 | SP-320 | Spring Pin | 1 | A01 | BB-634 | Ball Bearing | 1 |
| C01 | O-P3 | "O" Ring | 1 | A02 | BB-626 | Ball Bearing | 1 |
| CP No. | D-021019-00 | Lock Lever CP | | A03 | BB-EE3 | Ball Bearing | 1 |
| 121 | A-122121-00 | Throttle Valve Lever | 1 | A04 | BB-EE3 | Ball Bearing | 1 |
| 183 | H-001183-00 | Lock Key | 1 | B04 | SP-26 | Spring Pin | 1 |
| 184 | G-144184-00 | Lock Spring | 1 | B05 | NR-316.8 | Needle Roller | 2 |
| B02 | SP-218 | Spring Pin | 1 | B06 | NR-1.29 | Needle Roller | 25 |
| | | | | J01 | B-2 | Ball | 17 |

□ CP No. denotes the assembled parts comprising of more than 1 pc. of parts. The related parts are shown in the thick frame.

□ * 201 and 413 are supplied together with parts shown in ().

□ Specify parts number and quantity in ordering.

■ Standard Accessory :

F-102.....9.5mm Open-End Wrench 1.

SN-6.....6mm Snake Drill 1.