



USER MANUAL

BABY ANGLE DRILL

MODELS : FCD-6A-1



FCD-6A-1

SPECIFICATIONS

Model	Drilling Capacity (Guidance)		Stall Torque (about)			Free Speed (about)	Size of Spindle Tapped Part	Side to Center (about)		Overall Length (about)		Weight (about)		Air Consumption at Max. Output (about)		Air Hose Size	
	mm	in	N·m	kgf·cm	ft·lbs			rpm	in	mm	in	mm	in	kg	lb	m ³ /min	ft ³ /min
FCD-6A-1	6	1/4	2.5	25	1.8	2,500	1/4-28 Female	9.5	3/8	222	8 47/64	0.6	1.3	0.28	9.8	6.3	1/4

1/4" air inlet thread size. 6.3mm(1/4") air hose size.

Refer to instructions and warning for safety use enclosed in each tool box.

FUJI AIR TOOLS CO., LTD.

1-14, Kamiji 2-chome, Higashinari-ku, Osaka 537, Japan
 Tel : (06) 972-2335
 Fax : (06) 972-2250

BOLT & NUT SETTERS
SCREW DRIVERS

ABRASIVE TOOLS

DRILLS · TAPPERS

PERCUSSION TOOLS

AIR MOTORS & OTHERS

OTHER PRODUCTS

PARTS LIST MODEL: FCD-6A-1

EXPLODED VIEW

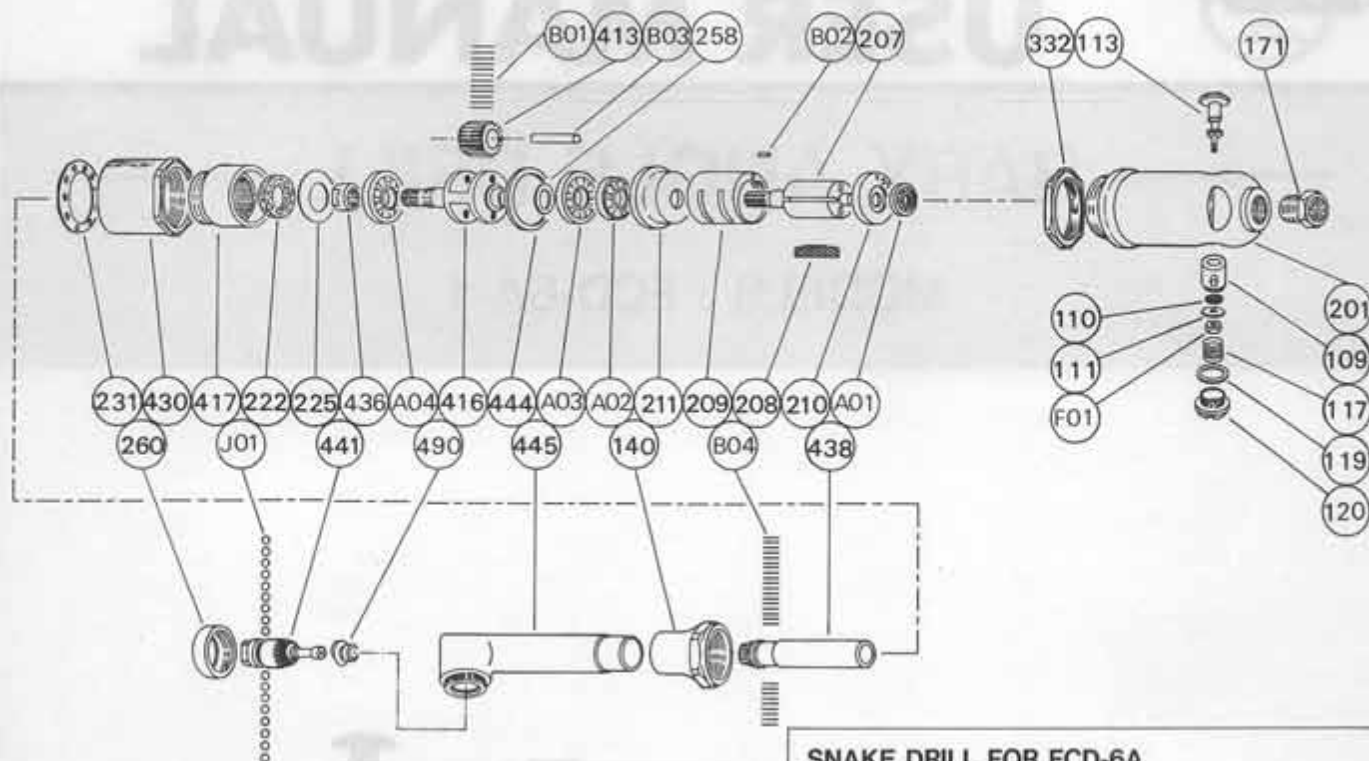

FCD-6A-1

SNAKE DRILL FOR FCD-6A

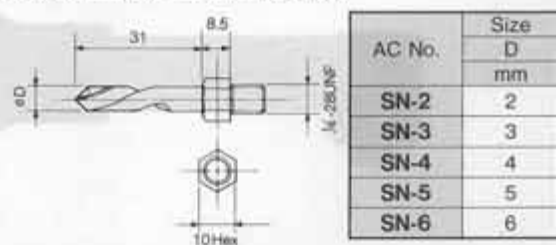

PARTS LIST

Index No.	Parts No.	Parts Name	Qt.	Index No.	Parts No.	Parts Name	Qt.
CP No.	D-022006-00	Housing CP		260	D-022260-00	Bearing Case	1
201	D-022301-00	Housing	1	332	D-022332-00	Lock Nut	1
109	D-022109-00	Throttle Valve Bushing	1	413	D-021413-00	No.1 Planet Gear	2
110	D-021110-00	Throttle Valve	1	(B01)	NR-19.5	Needle Roller	24
111	D-021111-00	Throttle Valve Washer	1	416	D-021416-00	No.1 Planet Gear Frame	1
113	D-022113-00	Throttle Valve Rod	1	417	D-021417-00	No.1 Internal Gear	1
117	D-021117-00	Throttle Valve Spring	1	430	D-022430-00	No.1 Gear Case	1
119	D-021119-00	T.V. Cover Packing	1	436	D-021436-00	Bearing Holder	1
120	D-021120-00	Throttle Valve Cover	1	438	D-021438-00	Spindle	1
171	1B-202000	Inlet Bushing (PT)	1	441	D-022441-00	Spindle (B)	1
171	1B-202N00	Inlet Bushing (NPT)	1	444	D-021444-00	Internal Gear Washer	1
F01	N-2	Nut	1	445	D-022445-00	Spindle Case	1
140	D-021140-00	Cup Nut	1	490	D-021490-00	Spindle Bushing	1
207	D-021207-00	Rotor	1	A01	BB-634	Ball Bearing	1
208	D-021208-00	Rotor Blade	4	A02	BB-626	Ball Bearing	1
209	D-021209-00	Cylinder	1	A03	BB-EE3	Ball Bearing	1
210	D-021210-00	Cylinder Upper Plate	1	A04	BB-EE3	Ball Bearing	1
211	D-021211-00	Cylinder Lower Plate	1	B02	SP-26	Spring Pin	1
222	D-021222-00	Felt Ring	1	B03	NR-316.8	Needle Roller	2
225	D-021225-00	Packing Washer	1	B04	NR-1.29	Needle Roller	25
231	D-021231-00	Silencer Plate	1	J01	B-2	Ball	17
258	D-058258-00	Washer (B)	1				

□ CP No. denotes the assembled parts comprising of more than 1 pc. of parts. The related parts are shown in the thick frame.

□ ≠ 413 is supplied together with parts shown in ().

□ Specify parts number and quantity in ordering.

■ Standard Accessories : F-102.....9.5Hex Open-End Wrench 1.
SN-6.....6mm Snake Drills 1.