

**EXPLODED VIEW**

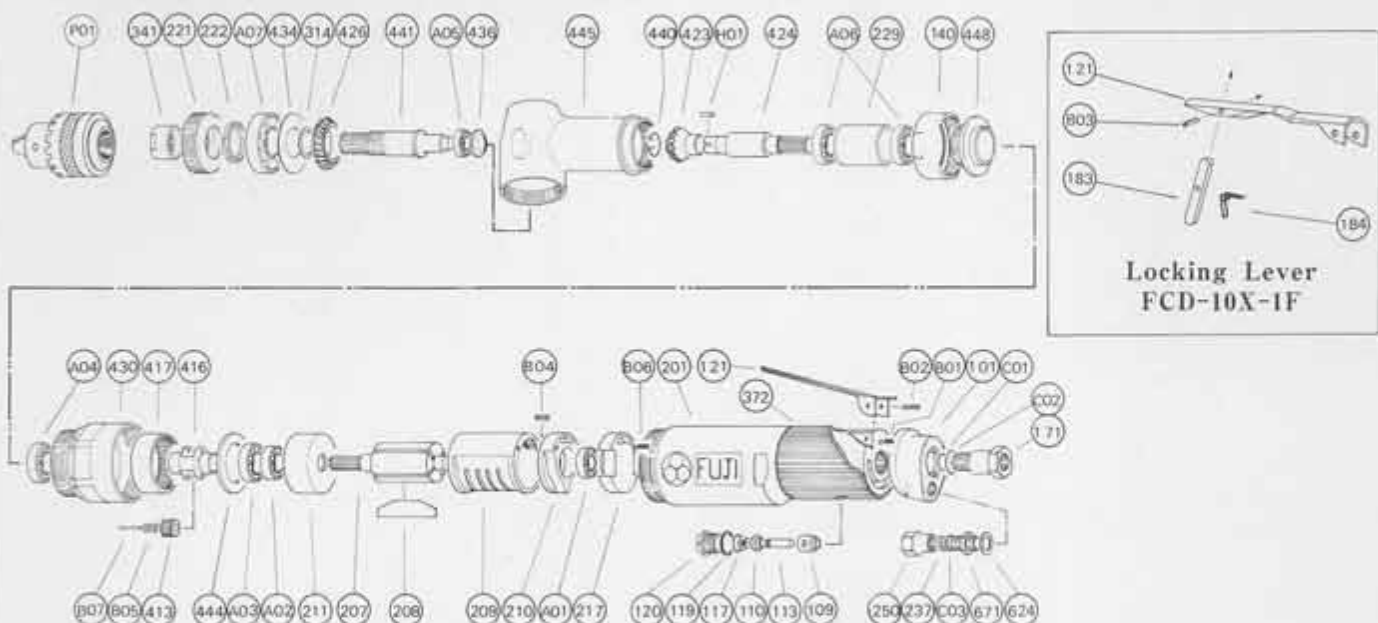

**PARTS LIST**

Index No.	Parts No.	Parts Name	Qt.	Index No.	Parts No.	Parts Name	Qt.	Index No.	Parts No.	Parts Name	Qt.
<b>LEVER HANDLE FCD-10X-1</b>				C01	O-S10	"O" Ring	1	413	D-120413-00	No.1 Planet Gear	2
CP No.	D-120006-00	Housing CP		C02	O-S16	"O" Ring	1	(B05)	NR-1.510.5	Needle Roller	22
101	D-120101-00	Housing Cover	1	C03	O-P10	"O" Ring	1	416	D-120416-00	No.1 Planet Gear Frame	1
109	D-120109-00	Throttle Valve Bushing	1	<b>CP No. H-014008-00 Throttle Valve Rod CP</b>				417	D-120417-00	No.1 Internal Gear	1
117	G-105117-00	Throttle Valve Spring	1	110	H-001110-02	Throttle Valve	1	423	D-120423-00	Bevel Pinion	1
119	G-028119-00	T.V. Cover Packing	1	113	H-014113-00	Throttle Valve Rod	1	424	D-120424-00	Bevel Pinion Spindle	1
120	G-028120-00	Throttle Valve Cover	1	<b>CP No. D-120019-00 Locking Lever CP</b>				426	D-120426-00	Bevel Gear	1
121	W-100121-00	Throttle Valve Lever	1	121	G-143121-01	Throttle Valve Lever	1	430	D-120430-00	No.1 Gear Case	1
171	G-146171-00	Inlet Joint (PT)	1	183	H-001183-00	Lock Key	1	434	D-120434-00	Bearing Washer	1
171	D-120171-00	Inlet Joint (NPT)	1	184	G-144184-00	Lock Spring	1	436	D-008436-00	Bearing Holder	1
201	D-120201-00	Housing	1	B03	SP-218	Spring Pin	1	440	A-107440-00	Ring	1
624	D-072624-00	Packing (D)	1					441	D-120441-00	Spindle (B)	1
671	D-072671-00	Exhaust Cover Joint	1	140	D-120140-00	Cup Nut	1	444	D-120444-00	Internal Gear Washer	1
B01	SP-2.56	Spring Pin	1	207	D-004207-00	Rotor	1	445	D-120445-00	Spindle Case	1
B02	SP-322	Spring Pin	1	208	G-042208-00	Rotor Blade	4	448	D-120448-00	Spindle Case Flange	1
C01	O-S10	"O" Ring	1	209	G-042209-00	Cylinder	1	A01	BB-626	Ball Bearing	1
C02	O-S16	"O" Ring	1	(B04)	SP-26	Spring Pin	2	A02	BB-6200	Ball Bearing	1
C03	O-P10	"O" Ring	1	210	D-120210-00	Cylinder Upper Plate	1	A03	BB-6002	Ball Bearing	1
<b>CP No. G-028008-00 Throttle Valve Rod CP</b>				211	D-080211-00	Cylinder Lower Plate	1	A04	BB-6002	Ball Bearing	1
110	H-001110-02	Throttle Valve	1	217	D-120217-00	Bearing Cover	1	A05	BB-608	Ball Bearing	1
113	G-028113-00	Throttle Valve Rod	1	221	A-124221-00	Spindle Bearing Cover	1	A06	BB-6200	Ball Bearing	2
<b>LOCKING LEVER HANDLE FCD-10X-1F</b>				222	A-006222-00	Felt Ring	1	A07	BB-6202	Ball Bearing	1
CP No.	D-120006-02	Housing CP		229	D-120229-00	Bearing Spacer	1	B06	SP-216	Spring Pin	1
101	D-120101-00	Housing Cover	1	237	D-072237-00	Muffler Pad	1	B07	NR-419	Needle Roller	2
109	D-120109-00	Throttle Valve Bushing	1	250	D-120250-00	Exhaust Cover	1	H01	K-338F	Key	1
117	G-105117-00	Throttle Valve Spring	1	314	A-004314-00	Wheel Spindle Washer	1	P01	DKK-10-1	Drill Chuck	1
119	G-028119-00	T.V. Cover Packing	1	341	D-120341-00	Chuck Collar	1				
120	G-028120-00	Throttle Valve Cover	1	372	D-120372-00	Plastic Cover	1				
171	G-146171-00	Inlet Joint (PT)	1								
171	D-120171-00	Inlet Joint (NPT)	1								
201	D-120201-00	Housing	1								
624	D-072624-00	Packing (D)	1								
671	D-072671-00	Exhaust Cover Joint	1								
B01	SP-2.56	Spring Pin	1								
B02	SP-322	Spring Pin	1								

■ Standard Accessory : 1 pc. Open-End Wrench

- CP No. denotes the assembled parts comprising of more than 1 pc. of parts. The related parts are shown in the thick frame.
- #209 and 413 are supplied together with parts shown in ( ).
- Specify parts number and quantity in ordering.

**MANUFACTURER:**  
**FUJI AIR TOOLS CO., LTD.**

1-14, Kamiji 2-chome, Higashinari-ku, Osaka 537, Japan  
Tel. : (06) 972-2335 (Overseas Dept) Fax : (06) 972-2250