



USER MANUAL

ANGLE GRINDERS

MODELS : FA-7E-5, -5F



FA-7E-5F



FA-7E-5

SPECIFICATIONS

Model	Max. Dia						Max. Free Speed min ⁻¹	Spindle Thread Size in	Angle Head Height (about)		Overall Length (about)		Mass (about)		Air Consumption Under Load (about)	
	Grinding Wheel		Sanding Disc		Cup Wire Brush				mm	in	mm	in	kg	lb	Nm ³ /min	lit ³ /min
	mm	in	mm	in	mm	in										
FA-7E-5	180x6x22.2	7x1/4x7/8	180x-x22.2	7x-x7/8	100x-x15.8	4x-x5/8	7,000	U5/8-11(M)	101	3 ³¹ /32	294	11 ³⁷ /64	3.1	6.9	1.40	49.5
FA-7E-5F	180x6x22.2	7x1/4x7/8	180x-x22.2	7x-x7/8	100x-x15.8	4x-x5/8	7,000	U5/8-11(M)	101	3 ³¹ /32	329	12 ⁶¹ /64	3.1	6.9	1.40	49.5

3/8" Air Inlet, 1/2" (12.7mm) Air Hose.

The performance figures are at 0.63MPa (6.3bar).

※ The models are supplied for use of Grinding Wheel. When the models are used with Sanding Disc or Wire Brush, the parts necessary to mount them on the models are necessary. Order separately.

Refer to "The Instructions and Warning for Safety Use" enclosed in each tool box.

FUJI AIR TOOLS CO., LTD.

2-1-14 Kamiji, Higashinari-ku, Osaka, 537-0003 Japan

Tel : (06) 6972-2335

Fax : (06) 6972-2250



PARTS LIST MODEL: FA-7E-5, -5F

EXPLODED VIEW

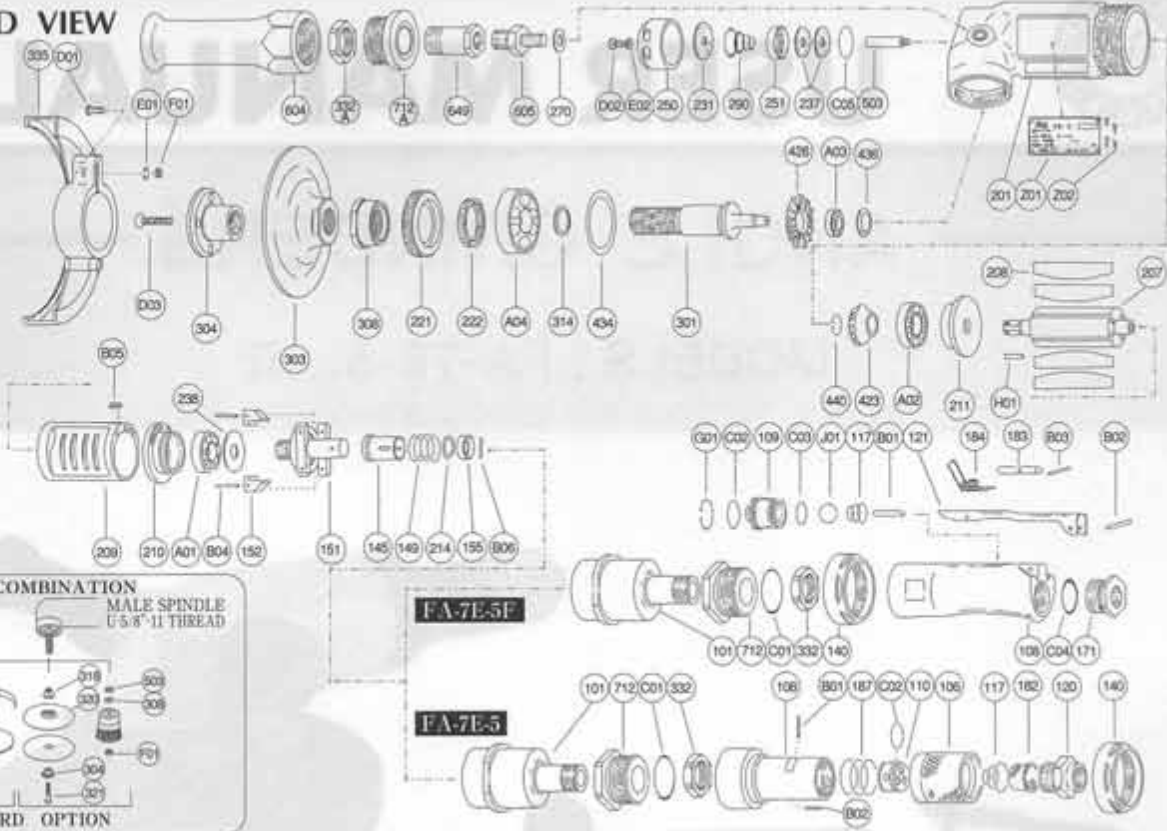

PARTS LIST

FA-7E-5, -5F

Index No.	Parts No.	Parts Name	Qt.	Index No.	Parts No.	Parts Name	Qt.	Index No.	Parts No.	Parts Name	Qt.
FA-7E-5				CP No.	A-192019-00	Lock Lever CP		301	A-193301-01	Wheel Spindle	1
				121	A-192121-00	Lock Lever	1	303	A-193303-01	Wheel Flange (A)	1
CP No.	A-193001-00	Housing Cover CP		183	G-144183-02	Lock Key	1	304	A-193304-03	Wheel Flange (B)	1
101	A-193101-00	Housing Cover	1	184	G-144184-00	Lock Spring	1	308	A-193308-00	Spacer	1
332	A-192332-00	Lock Nut	1	B03	SP-218	Spring Pin	1	314	A-109314-00	Wheel Spindle Washer (T=0.5)	1
712	A-192712-00	Damper	1	FA-7E-5 FA-7E-5F				314	A-109314-01	Wheel Spindle Washer (T=0.3)	1
C01	O-S29	* O' Ring	1	CP No.	A-193010-00	Governor Weight CP		314	A-109314-02	Wheel Spindle Washer (T=0.2)	1
CP No.	A-193003-00	Throttle Valve CP		151	A-193151-00	Governor Cage	1	335	A-193335-01	Wheel Guard	1
106	A-077106-03	Throttle Valve Handle	1	152	G-053152-00	Governor Weight	2	D01	HS-625	Hexagon Bolt	1
108	A-193108-00	Throttle Valve Body	1	B04	GP-2524GCH	Grooved Pin	2	E01	SW-6	Spring Washer	1
110	A-077110-00	Throttle Valve	1	FA-7E-5 FA-7E-5F				F01	N-6	Nut	1
117	A-077117-00	Throttle Valve Spring	1	CP No.	A-192014-00	Dead Handle CP		423	A-109423-00	Bevel Pinion	1
120	A-077120-00	Throttle Valve Cover (PT)	1	604	A-192604-00	Dead Handle	1	426	A-109426-00	Bevel Gear	1
120	A-077120-01	Throttle Valve Cover (NPT)	1	CP No.	A-192039-00	Damper CP		434	A-025434-00	Bearing Washer	1
182	W-057182-00	Strainer	1	332A	A-192332-00	Lock Nut	1	436	D-008436-00	Bearing Holder	1
187	A-077187-01	Throttle Valve Handle Spring	1	649	A-192649-00	Joint	1	440	A-109440-00	Ring	1
B01	NR-415	Needle Roller	1	712A	A-192712-01	Damper	1	503	A-193503-00	Spacer (B)	1
B02	NR-413	Needle Roller	1	140	A-077140-00	Cup Nut (For FA-7E-5)	1	605	A-108605-00	Dead Handle Joint	1
C02	O-S22	* O' Ring	1	145	A-077145-00	Governor Valve	1	A01	BB-6002MN	Ball Bearing	1
FA-7E-5F				149	A-077149-03	Governor Valve Spring	1	A02	BB-6301	Ball Bearing	1
CP No.	A-193001-01	Housing Cover CP		155	A-069155-00	Governor Valve Spring Holder	1	A03	BB-608	Ball Bearing	1
101	A-193101-00	Housing Cover	1	201	A-193201-00	Housing	1	A04	BB-6204ZZ	Ball Bearing	1
140	A-077140-00	Cup Nut	1	207	A-193207-00	Rotor	1	B06	NR-2515.8	Needle Roller	1
332	A-192332-00	Lock Nut	1	208	A-193208-00	Rotor Blade	4	C05	O-S32	* O' Ring	1
712	A-192712-00	Damper	1	209	A-193209-00	Cylinder	1	D02	CS-58B	Cap Screw	1
C01	O-S29	* O' Ring	1	(B05)	SP-38	Spring Pin	1	D03	CS-630S	Cap Screw	1
CP No.	A-192003-01	Throttle Valve Body CP		210	A-109210-00	Cylinder Upper Plate	1	E02	PW-5	Plain Washer	1
108	A-192108-01	Throttle Valve Body	1	211	A-109211-00	Cylinder Lower Plate	1	H01	K-4410F	Key	1
109	A-192109-00	Throttle Valve Bushing	1	214	A-069214-00	Adjusting Washer (T=0.2)	1	Z01	NP-0114	Name Plate	1
117	A-192117-00	Throttle Valve Spring	1	214	A-069214-01	Adjusting Washer (T=0.3)	1	Z02	NPN-0x32	Screw Rivet	4
171	A-192171-00	Inlet Joint (PT)	1	214	A-069214-02	Adjusting Washer (T=0.5)	1	OPTION			
171	A-192171-01	Inlet Joint (NPT)	1	221	A-193221-00	Spindle Bearing Washer	1	Sanding Disc			
B01	NR-423FR	Needle Roller	1	222	A-193222-00	Felt Ring	1	304	A-193304-01	Wheel Flange (B)	1
B02	SP-320	Spring Pin	1	231	A-193231-00	Silencer Plate	1	318	A-087318-00	Rubber Pad Flange	1
C02	O-S16	* O' Ring	1	237	A-193237-00	Muffler Pad	2	320	RP-7	Rubber Backing Pad	1
C03	O-S14	* O' Ring	1	238	A-109238-00	Bearing Cover (B)	1	321	A-070321-00	Detent Bolt	1
C04	O-P20	* O' Ring	1	250	A-193250-01	Exhaust Cover	1	Wire Brush			
G01	SR-R20	Snap Ring	1	251	A-193251-00	Exhaust Valve	1	308	A-009308-00	Spacer	1
J01	B-9/16U	Urethan Ball	1	270	H-001270-00	Conical Spring Washer	1	503	A-020503-A	Spacer (B)	1
				290	A-192290-00	Muffler Spring	1	F01	N-U5/8	Nut	1

□ CP No. denotes the assembled parts comprising of more than 1 pc. of parts.

The related parts are shown in the thick frame.

□ #209 and 335 are supplied together with parts shown in ().

□ Specify parts number and quantity in ordering.

■ Standard Accessories : F-704 4mm Hex. Pin Wrench 1.
P-109 24mm Open-End Wrench 1.
F-203 32mm Open-End Pin Wrench 1.