



USER MANUAL

ANGLE GRINDERS

MODELS : FA-7E-1V, -1VF



FA-7E-1VF



FA-7E-1V

SPECIFICATIONS

Model	Max. Dia.						Max. Free Speed min ⁻¹	Spindle Thread Size in	Angle Head Height (about)		Overall Length (about)		Mass (about)		Air Consumption Under Load (about)	
	Grinding Wheel		Sanding Disc		Cup Wire Brush				mm	in	mm	in	kg	lb	Nm ³ /min	lit/min
	mm	in	mm	in	mm	in										
FA-7E-1V	180x6x22.2	7x1/4x7/8	180x-x22.2	7x-x7/8	100x-x15.8	4x-x5/8	7,000	W1/2-16(F)	87	3 27/64	272	10 45/64	3.1	6.9	1.40	49.5
FA-7E-1VF	180x6x22.2	7x1/4x7/8	180x-x22.2	7x-x7/8	100x-x15.8	4x-x5/8	7,000	W1/2-16(F)	87	3 27/64	307	12 3/32	3.1	6.9	1.40	49.5

3/8" Air Inlet, 1/2" (12.7mm) Air Hose.

The performance figures are at 0.63MPa (6.3bar).

* The models are supplied for use of Grinding Wheel. When the models are used with Sanding Disc or Wire Brush, the parts necessary to mount them on the models are necessary. Order separately.



Refer to "The Instructions and Warning for Safety Use" enclosed in each tool box.

FUJI AIR TOOLS CO., LTD.

2-1-14 Kamiji, Higashinari-ku, Osaka, 537-0003 Japan

Tel : (06) 6972-2335

Fax : (06) 6972-2250



BOLT & NUT SETTERS
SCREW DRIVERS

ABRASIVE TOOLS

DRILLS • TAPPERS

PERCUSSION TOOLS

AIR MOTORS & OTHERS

OTHER PRODUCTS



PARTS LIST MODEL: FA-7E-1V, -1VF

EXPLODED VIEW

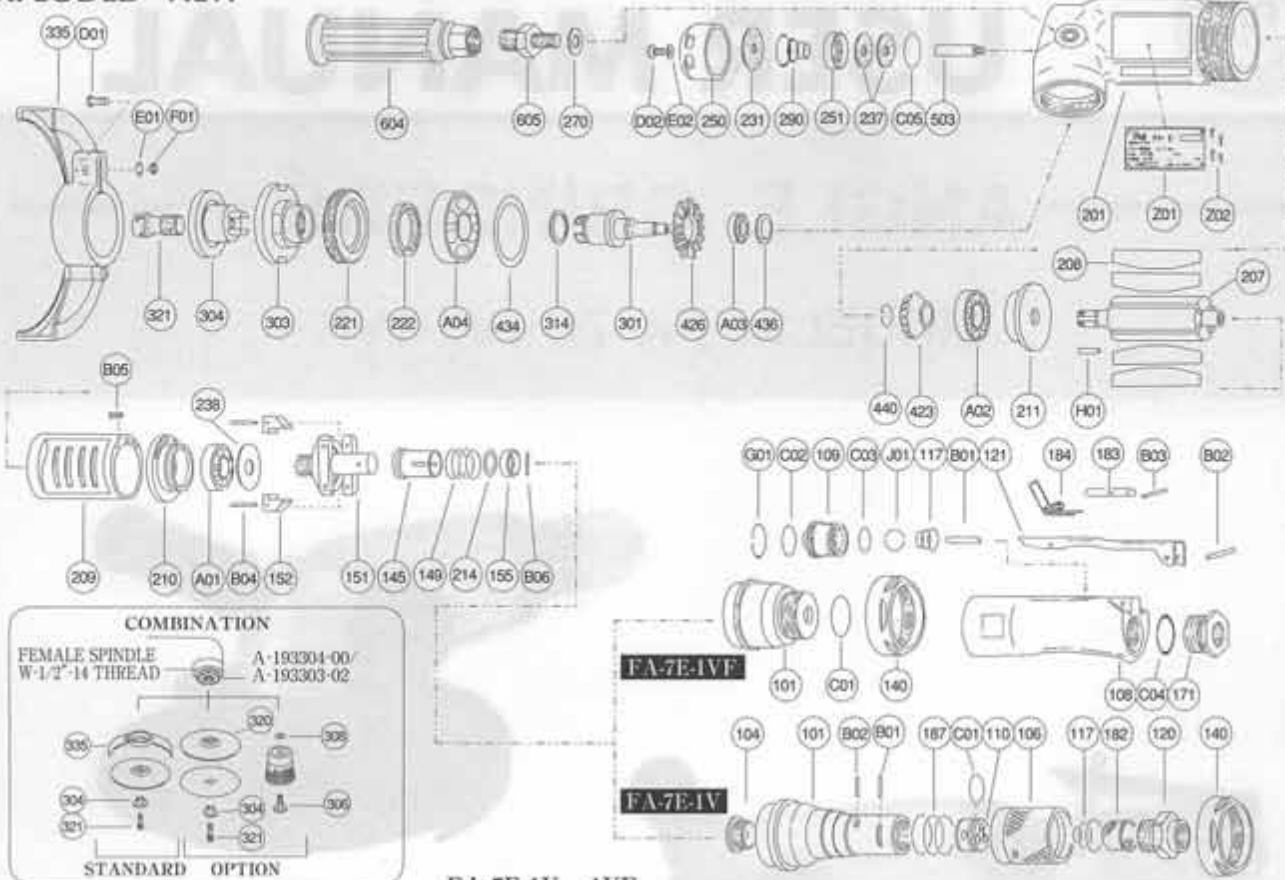

FA-7E-1V, -1VF

PARTS LIST

Index No.	Parts No.	Parts Name	Qt.	Index No.	Parts No.	Parts Name	Qt.	Index No.	Parts No.	Parts Name	Qt.
FA-7E-1V				FA-7E-1V FA-7E-1VF				(D01)	HS-625	Hexagon Bolt	1
CP No.	A-077001-01	Housing Cover CP		CP No.	A-193010-00	Governor Weight CP		(E01)	SW-6	Spring Washer	1
101	A-077101-03	Housing Cover	1	151	A-193151-00	Governor Cage	1	(F01)	N-6	Nut	1
104	A-077104-01	Bushing	1	152	G-053152-00	Governor Weight	2	423	A-109423-00	Bevel Pinion	1
106	A-077106-03	Throttle Valve Handle	1	B04	GP-2524GCH	Grooved Pin	2	426	A-109426-00	Bevel Gear	1
110	A-077110-00	Throttle Valve	1	140	A-077140-00	Cup Nut (For FA-7E-1V)	1	434	A-025434-00	Bearing Washer	1
117	A-077117-00	Throttle Valve Spring	1	145	A-077145-00	Governor Valve	1	436	D-008436-00	Bearing Holder	1
120	A-077120-00	Throttle Valve Cover (PT)	1	149	A-077149-03	Governor Valve Spring	1	440	A-109440-00	Ring	1
120	A-077120-01	Throttle Valve Cover (NPT)	1	155	A-069155-00	Governor Valve Spring Holder	1	503	A-193503-00	Spacer (B)	1
182	W-057182-00	Strainer	1	201	A-193201-00	Housing	1	604	A-025604-02	Dead Handle	1
187	A-077187-01	Throttle Valve Handle Spring	1	207	A-193207-00	Rotor	1	605	A-108605-00	Dead Handle Joint	1
B01	NR-415	Needle Roller	1	208	A-193208-00	Rotor Blade	4	A01	BB-6002MN	Ball Bearing	1
B02	NR-413	Needle Roller	1	209	A-193209-00	Cylinder	1	A02	BB-6301	Ball Bearing	1
C01	O-S22	"O" Ring	1	(B05)	SP-38	Spring Pin	1	A03	BB-608	Ball Bearing	1
FA-7E-1VF				210	A-109210-00	Cylinder Upper Plate	1	A04	BB-6204ZZ	Ball Bearing	1
CP No.	A-193001-02	Housing Cover CP		211	A-109211-00	Cylinder Lower Plate	1	B06	NR-2.515.8	Needle Roller	1
101	A-193101-01	Housing Cover	1	214	A-069214-00	Adjusting Washer (T=0.2)	1	C05	O-S32	"O" Ring	1
140	A-077140-00	Cup Nut	1	214	A-069214-01	Adjusting Washer (T=0.3)	1	D02	CS-58B	Cap Screw	1
C01	O-S29	"O" Ring	1	214	A-069214-02	Adjusting Washer (T=0.5)	1	E02	PW-5	Plain Washer	1
CP No.	A-192003-01	Throttle Valve Body CP		221	A-193221-00	Spindle Bearing Washer	1	H01	K-4410F	Key	1
108	A-192108-01	Throttle Valve Body	1	222	A-193222-00	Felt Ring	1	Z01	NP-0107	Name Plate	1
109	A-192109-00	Throttle Valve Bushing	1	231	A-193231-00	Silencer Plate	1	Z02	NPN-0x3.2	Screw Rivet	4
117	A-192117-00	Throttle Valve Spring	1	237	A-193237-00	Muffler Pad	2	OPTION			
171	A-192171-00	Inlet Joint (PT)	1	238	A-109238-00	Bearing Cover (B)	1	Sanding Disc			
171	A-192171-01	Inlet Joint (NPT)	1	250	A-193250-01	Exhaust Cover	1	304	A-193304-01	Wheel Flange (B)	1
B01	NR-423FR	Needle Roller	1	251	A-193251-00	Exhaust Valve	1	320	RP-7	Rubber Backing Pad	1
B02	SP-320	Spring Pin	1	270	H-001270-00	Conical Spring Washer	1	321	A-070321-00	Detent Bolt	1
C02	O-S16	"O" Ring	1	290	A-192290-00	Muffler Spring	1	Wire Brush			
C03	O-S14	"O" Ring	1	301	A-193301-00	Wheel Spindle	1	306	A-103306-00	Wire Brush Holder Flange	1
C04	O-P20	"O" Ring	1	303	A-193303-00	Wheel Flange (A)	1	308	A-009308-00	Spacer	1
G01	SR-R20	Snap Ring	1	304	A-193304-01	Wheel Flange (B)	1	Wire Brush			
J01	B-9/16U	Urethan Ball	1	314	A-109314-00	Wheel Spindle Washer (T=0.5)	1	Wire Brush			
CP No.	A-192019-00	Lock Lever CP		314	A-109314-01	Wheel Spindle Washer (T=0.3)	1	Wire Brush			
121	A-192121-00	Lock Lever	1	314	A-109314-02	Wheel Spindle Washer (T=0.2)	1	Wire Brush			
183	G-144183-02	Lock Key	1	321	A-070321-00	Detent Bolt	1	Wire Brush			
184	G-144184-00	Lock Spring	1	335	A-193335-00	Wheel Guard	1	Wire Brush			
B03	SP-218	Spring Pin	1					Wire Brush			

□ CP No. denotes the assembled parts comprising of more than 1 pc. of parts. The related parts are shown in the thick frame.

□ #209 and 335 are supplied together with parts shown in ().

□ Specify parts number and quantity in ordering.

■ Standard Accessories : F-708 8mm Hex. Pin Wrench 1.

F-110 26mm Open-End Wrench 1.