

EXPLODED VIEW

5E-13, -13F

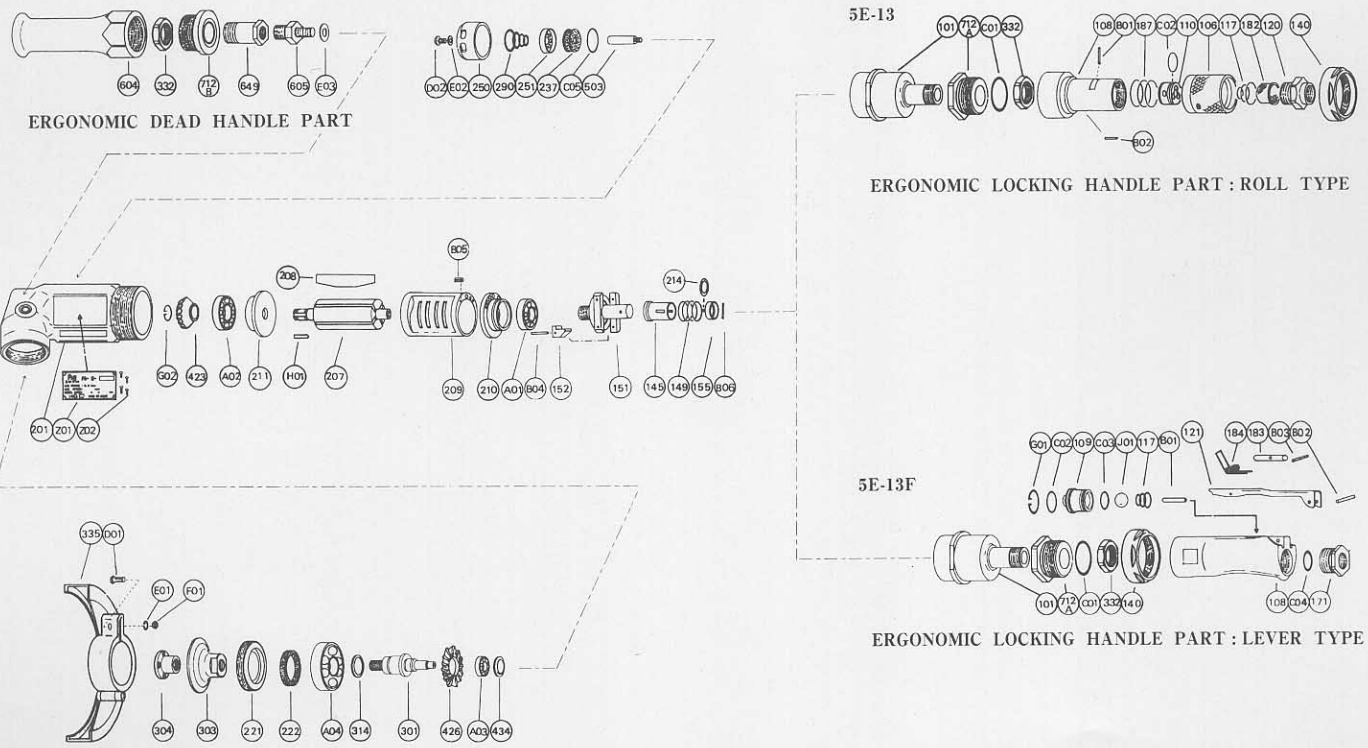

FA-5E-13, -13F

PARTS LIST

| Index No. | Parts No. | Parts Name | Qt. | Index No. | Parts No. | Parts Name | Qt. | Index No. | Parts No. | Parts Name | Qt. |
|--|-------------|------------------------------|-----|-----------------|-------------|------------------------------|-----|--|-------------|------------------------------|-----|
| FA-5E-13 (ERGONOMIC) LOCKING HANDLE ROLL TYPE | | | | FA-5E-13 | | | | FA-5E-13F (ERGONOMIC) LOCKING HANDLE LEVER TYPE | | | |
| CP No. | A-192001-00 | Housing Cover CP | | CP No. | A-192019-00 | Locking Lever CP | | CP No. | A-192039-00 | Damper CP | |
| 101 | A-192101-00 | Housing Cover | 1 | 121 | A-192121-00 | Throttle Valve Lever | 1 | 332 | A-192332-00 | Lock Nut | 1 |
| 332 | A-192332-00 | Lock Nut | 1 | 183 | G-144183-02 | Lock Key | 1 | 649 | A-192649-00 | Joint | 1 |
| 712A | A-192712-00 | Damper | 1 | 184 | G-144184-00 | Lock Spring | 1 | 712B | A-192712-01 | Damper | 1 |
| C01 | O-S29 | "O" Ring | 1 | B03 | SP-218 | Spring Pin | 1 | 140 | A-154140-00 | Cup Nut | 1 |
| CP No. | A-192003-00 | Throttle Valve Body CP | | FA-5E-13 | | | | FA-5E-13F | | | |
| 106 | A-086106-00 | Throttle Valve Handle | 1 | CP No. | A-107010-00 | Governor Weight CP | | 145 | A-065145-00 | Governor Valve | 1 |
| 108 | A-192108-00 | Throttle Valve Body | 1 | 151 | A-107151-01 | Governor Cage | 1 | 149 | A-093149-03 | Governor Valve Spring | 1 |
| 110 | A-086110-00 | Throttle Valve | 1 | 152 | A-010152-00 | Governor Weight | 2 | 155 | A-065155-00 | Governor Valve Spring Holder | 1 |
| 117 | A-086117-00 | Throttle Valve Spring | 1 | B04 | GP-2.516GCH | Grooved Pin | 2 | 201 | A-192201-00 | Housing | 1 |
| 120 | A-086120-00 | Throttle Valve Cover (PT) | 1 | CP No. | A-192014-00 | Dead Handle CP | | 207 | A-192207-00 | Rotor | 1 |
| 120 | A-086120-01 | Throttle Valve Cover (NPT) | 1 | 604 | A-192604-00 | Dead Handle | 1 | 208 | A-152208-00 | Rotor Blade | 4 |
| 182 | A-086182-00 | Strainer | 1 | CP No. | A-192039-00 | Damper CP | | 209 | A-152209-00 | Cylinder | 1 |
| 187 | A-086187-00 | Throttle Valve Handle Spring | 1 | 332 | A-192332-00 | Lock Nut | 1 | (B05) | SP-2.56 | Spring Pin | 1 |
| B01 | NR-415 | Needle Roller | 1 | 649 | A-192649-00 | Joint | 1 | 210 | A-192210-00 | Cylinder Upper Plate | 1 |
| B02 | NR-413 | Needle Roller | 1 | 712B | A-192712-01 | Damper | 1 | 211 | A-152211-01 | Cylinder Lower Plate | 1 |
| C02 | O-S20 | "O" Ring | 1 | 140 | A-154140-00 | Cup Nut | 1 | 214 | A-065214-00 | Adjusting Washer (T=0.2) | 1 |
| FA-5E-13F (ERGONOMIC) LOCKING HANDLE LEVER TYPE | | | | FA-5E-13 | | | | FA-5E-13F | | | |
| CP No. | A-192001-01 | Housing Cover CP | | 151 | A-107151-01 | Governor Cage | 1 | 214 | A-065214-01 | Adjusting Washer (T=0.3) | 1 |
| 101 | A-192101-00 | Housing Cover | 1 | 152 | A-010152-00 | Governor Weight | 2 | | | | |
| 140 | A-154140-00 | Cup Nut | 1 | B04 | GP-2.516GCH | Grooved Pin | 2 | | | | |
| 332 | A-192332-00 | Lock Nut | 1 | CP No. | A-192014-00 | Dead Handle CP | | | | | |
| 712A | A-192712-00 | Damper | 1 | 604 | A-192604-00 | Dead Handle | 1 | | | | |
| C01 | O-S29 | "O" Ring | 1 | CP No. | A-192039-00 | Damper CP | | | | | |
| CP No. | A-192003-01 | Throttle Valve Body CP | | 332 | A-192332-00 | Lock Nut | 1 | | | | |
| 108 | A-192108-01 | Throttle Valve Body | 1 | 649 | A-192649-00 | Joint | 1 | | | | |
| 109 | A-192109-00 | Throttle Valve Bushing | 1 | 712B | A-192712-01 | Damper | 1 | | | | |
| 117 | A-192117-00 | Throttle Valve Spring | 1 | 140 | A-154140-00 | Cup Nut | 1 | | | | |
| 171 | A-192171-00 | Inlet Joint | 1 | 145 | A-065145-00 | Governor Valve | 1 | | | | |
| 171 | A-192171-01 | Inlet Joint | 1 | 149 | A-093149-03 | Governor Valve Spring | 1 | | | | |
| B01 | NR-423FR | Needle Roller | 1 | 155 | A-065155-00 | Governor Valve Spring Holder | 1 | | | | |
| B02 | SP-320 | Spring Pin | 1 | 201 | A-192201-00 | Housing | 1 | | | | |
| | | | | 207 | A-192207-00 | Rotor | 1 | | | | |
| | | | | 208 | A-152208-00 | Rotor Blade | 4 | | | | |
| | | | | 209 | A-152209-00 | Cylinder | 1 | | | | |
| | | | | (B05) | SP-2.56 | Spring Pin | 1 | | | | |
| | | | | 210 | A-192210-00 | Cylinder Upper Plate | 1 | | | | |
| | | | | 211 | A-152211-01 | Cylinder Lower Plate | 1 | | | | |
| | | | | 214 | A-065214-00 | Adjusting Washer (T=0.2) | 1 | | | | |
| | | | | 214 | A-065214-01 | Adjusting Washer (T=0.3) | 1 | | | | |
| | | | | 214 | A-065214-02 | Adjusting Washer (T=0.5) | 1 | | | | |
| | | | | 221 | A-192221-00 | Spindle Bearing Cover | 1 | | | | |
| | | | | 222 | A-006222-00 | Felt Ring | 1 | | | | |
| | | | | 237 | A-192237-00 | Muffler Pad | 2 | | | | |
| | | | | 250 | A-192250-01 | Exhaust Cover | 1 | | | | |
| | | | | 251 | A-192251-00 | Exhaust Valve | 1 | | | | |
| | | | | 290 | A-192290-00 | Muffler Spring | 1 | | | | |
| | | | | 301 | A-192301-01 | Wheel Spindle | 1 | | | | |
| | | | | 303 | A-192303-01 | Wheel Flange (A) | 1 | | | | |
| | | | | 304 | A-192304-02 | Wheel Flange (B) | 1 | | | | |
| | | | | 314 | A-006314-00 | Wheel Spindle Washer (T=0.2) | 1 | | | | |
| | | | | 314 | A-006314-01 | Wheel Spindle Washer (T=0.3) | 1 | | | | |
| | | | | 314 | A-006314-02 | Wheel Spindle Washer (T=0.5) | 1 | | | | |
| | | | | 335 | A-192335-00 | Wheel Guard | 1 | | | | |
| | | | | (D01) | HS-625 | Hexagon Bolt | 1 | | | | |
| | | | | E01 | SW-6 | Spring Washer | 1 | | | | |
| | | | | F01 | N-6 | Nut | 1 | | | | |
| | | | | 423 | A-192423-00 | Bevel Pinion | 1 | | | | |
| | | | | 426 | A-192426-00 | Bevel Gear | 1 | | | | |
| | | | | 434 | A-099434-00 | Bearing Washer | 1 | | | | |
| | | | | 503 | A-192503-00 | Spacer (B) | 1 | | | | |
| | | | | 605 | A-107605-00 | Dead Handle Joint | 1 | | | | |
| | | | | A01 | BB-609MN | Ball Bearing | 1 | | | | |
| | | | | A02 | BB-6000MN | Ball Bearing | 1 | | | | |
| | | | | A03 | BB-606 | Ball Bearing | 1 | | | | |
| | | | | A04 | BB-6003ZZ | Ball Bearing | 1 | | | | |
| | | | | B06 | NR-211.8 | Needle Roller | 1 | | | | |
| | | | | C05 | O-S30 | "O" Ring | 1 | | | | |
| | | | | D02 | CS-58B | Cap Screw | 1 | | | | |
| | | | | E02 | PW-5 | Plain Washer | 1 | | | | |
| | | | | E03 | PW-8 | Plain Washer | 1 | | | | |
| | | | | G02 | SR-SA9 | Snap Ring | 1 | | | | |
| | | | | H01 | K-338F | Key | 1 | | | | |
| | | | | Z01 | NP-0115 | Name Plate | 1 | | | | |
| | | | | Z02 | NPN-0X3.2 | Screw Rivet | 4 | | | | |

- CP No. denotes the assembled parts comprising of more than 1 pc. of parts.
- #209 is supplied together with parts shown in ().
- Specify parts number and quantity in ordering.
- The related parts are shown in the thick frame.
- Standard Accessories: 1 pc. Open-End Wrench.
1 pc. Hex. Pin Wrench.

MANUFACTURER: **FUJI AIR TOOLS CO., LTD.**

1-14, Kamiji 2-chome, Higashinari-ku, Osaka 537, Japan
Tel.: (06) 972-2335 (Overseas Dept) Fax: (06) 972-2250