



USER MANUAL

— IMPACT WRENCH & SCREW DRIVER — (IMPACT CLUTCH TYPE) MODELS : FW-5PX-6 & FW-5PXD-6, -60



FW-5PX-6



FW-5PXD-6, -60

SPECIFICATIONS

Model	Capacity Bolt or Screw size (Guidance)		Rotational Frequency	Distance from Center to Side		Square Drive Size		Bit Shank Size		Overall Length (without socket)		Mass (without socket)		Air Consumption (At Load)		Air Hose Size	
	mm	in		mm	in	mm	in	mm	in	mm	in	kg	lb	m ³ /min	ft ³ /min	mm	in
FW-5PX-6	5	3/16	12,000	17.0	43/64	9.5	3/8	—	—	150	5 29/32	0.80	1.8	0.20	7.1	6.3	1/4
FW-5PXD-6, -60	5	3/16	12,000	17.0	43/64	—	—	6.35	1/4	160	6 19/64	0.80	1.8	0.20	7.1	6.3	1/4

* Air Inlet Thread Size : PT or NPT 1/4".

The performance figures are at 0.63MPa (6.3bar).

⚠ Refer to "The Instructions and Warning for Safety Use" enclosed in each tool box.

FUJI AIR TOOLS CO., LTD.

2-1-14 Kamiji, Higashinariku, Osaka 537-0003, Japan

Tel : (06) 6972-2335

Fax : (06) 6972-2250

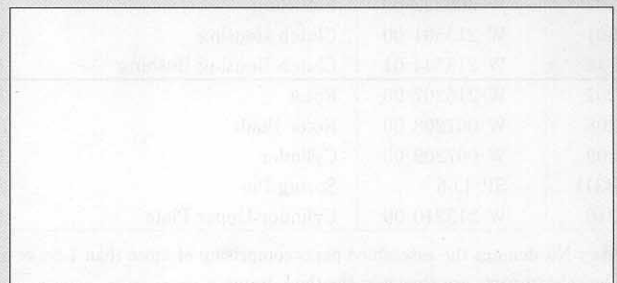

BOLT & NUT SETTERS
SCREW DRIVERS

ABRASIVE TOOLS

DRILLS • TAPPERS

PERCUSSION TOOLS

AIR MOTORS & OTHERS

OTHER PRODUCTS

PARTS LIST MODEL: FW-5PX-6 & FW5PXD-6, -60

EXPLODED VIEW

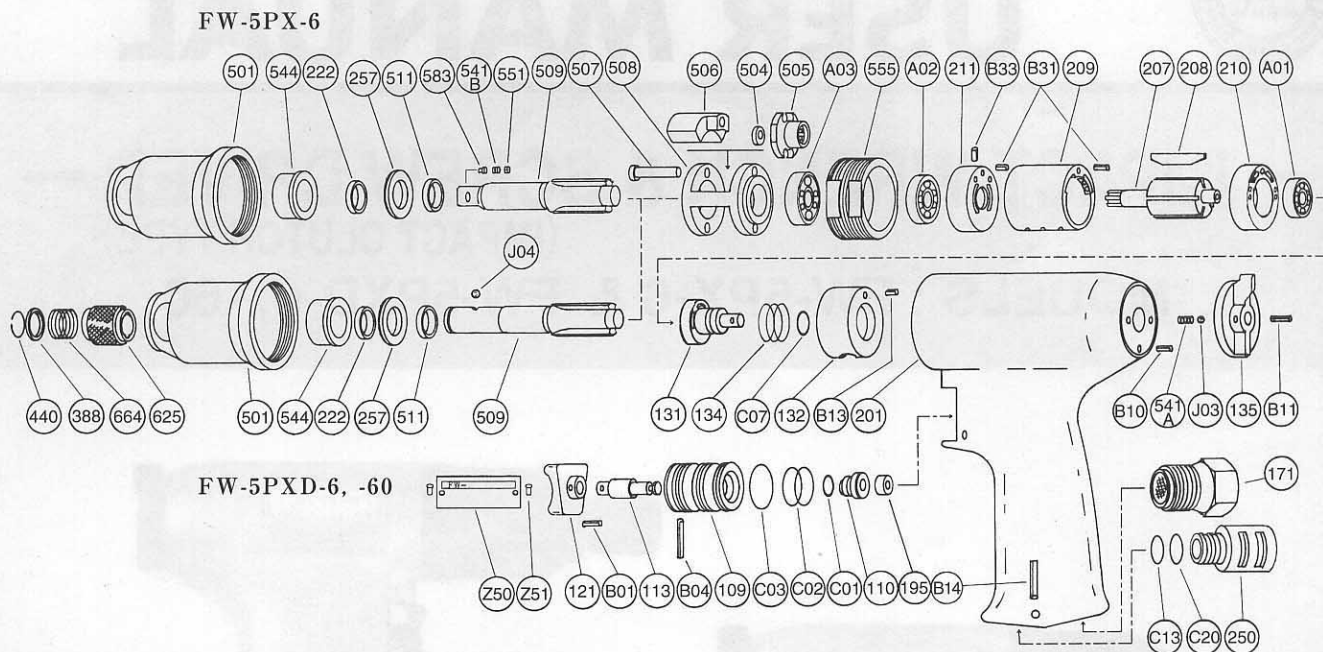

PARTS LIST

Index No.	Parts No.	Parts Name	Qt.	Index No.	Parts No.	Parts Name	Qt.
FW-5PX-6							
FW-5PXD-6, -60							
Ass'y No.	W-215006-02	Housing Ass'y		211	W-216211-00	Cylinder Lower Plate	1
109	W-215109-01	Throttle Valve Bushing	1	(B33)	SP-1.64	Spring Pin	1
110	W-215110-00	Throttle Valve	1	250	W-215250-00	Exhaust Cover	1
113	W-215113-00	Throttle Valve Rod	1	257	D-026257-00	Washer	1
121	W-215121-00	Trigger	1	504	W-215504-00	Spacer <C>	1
131	W-215131-01	Reverse Valve	1	505	W-215505-01	Cam	1
132	W-215132-01	Reverse Valve Bushing	1	506	W-215506-01	Hammer Clutch	2
134	W-215134-00	Reverse Valve Spring	1	507	W-067507-00	Clutch Pin	2
135	W-215135-01	Reverse Valve Lever	1	508	W-215508-01	Clutch Frame	1
171	W-025171-00	Inlet Joint <PT> or	1	509	W-221509-04	Anvil 	1
	W-025171-01	Inlet Joint <NPT>	1	(541B)	W-252541-00	Button Retainer Spring <F>	1
195	W-017195-00	Sub Throttle Valve	1	551	W-252551-00	Plug	1
201	W-215201-02	Housing	1	(583)	W-252583-00	Retainer Button <F>	1
541A	W-025541-00	Button Retainer Spring	2	511	W-215511-00	Clutch Frame Bushing	1
B01	SP-26	Spring Pin	1	555	W-215555-01	Clutch Housing Joint	1
B04	SP-2.522	Spring Pin	1	A01	BB-696	Ball Bearing	1
B10	SP-36	Spring Pin	1	A02	BB-607	Ball Bearing	1
B11	SP-210	Spring Pin	1	A03	BB-6901	Ball Bearing	1
B13	SP-25	Spring Pin	1	B14	SP-322	Spring Pin	1
C01	O-P5	" O " Ring	1	C13	O-S10	" O " Ring	1
C02	O-S12.5	" O " Ring	2	C20	O-S12	" O " Ring	1
C03	O-S14	" O " Ring	1	Z50	NP-1054	Name Plate	1
C07	O-P6	" O " Ring	1	Z51	NPN-0X3.2	Screw Rivet	2
J03	B-3	Ball	2	Following parts are necessary for FW-5PXD-6, -60 eliminating (509) (Z50) of FW-5PX-6.			
Ass'y No.	W-215013-01	Clutch Housing Ass'y		FW-5PXD-6, -60			
222	W-306222-00	Felt Ring	1	388	W-305388-00	Spring Holder	1
501	W-215501-00	Clutch Housing	1	440	W-305440-00	Ring	1
544	W-215544-01	Clutch Housing Bushing	1	509	W-215509-02	Anvil <D> <for FW-5PXD-6>	1
207	W-216207-00	Rotor	1	509	W-215509-03	Anvil <D> <for FW-5PXD-60>	1
208	W-067208-00	Rotor Blade	5	625	W-305625-00	Bit Cover	1
209	W-067209-00	Cylinder	1	664	W-305664-00	Finder Spring	1
(B31)	SP-1.66	Spring Pin	2	J04	B-3	Ball	1
210	W-215210-00	Cylinder Upper Plate	1	Z50	NP-1051	Name Plate <for FW-5PXD-6>	1
				Z50	NP-1051	Name Plate <for FW-5PXD-60>	1

□ Ass'y No. denotes the assembled parts comprising of more than 1 pc. of parts. The related parts are shown in the thick frame.
 □ #209, 211 and 509 are supplied together with parts shown in ().

□ Specify parts number and quantity in ordering.
 ■ Standard Accessories :
 FW-5PXD-6.....PB-2-3(75mm) Driver Bits 1.