



USER MANUAL

IMPACT WRENCH & DRIVER

MODELS : FW-44P-2, -44PD-2, -20



FW-44P-2



FW-44PD-2, -20

SPECIFICATIONS

Model	Capacity (Guidance)		Free Speed min ⁻¹	Side to Center		Square Drive Size		Bit Shank Size		Overall Length		Mass		Air Consumption (Under Load)		Air Inlet Thread Size		Air Hose Size	
	mm	in		mm	in	mm	in	mm	in	mm	in	kg	lb	Nm ³ /min	Nft ³ /min	in	mm	in	
FW-44P-2	5	3/16	7,500	17.0	43/64	9.5	3/8	—	—	122	4 51/64	0.78	1.7	0.45	15.9	PT or NPT 1/4	6.3	1/4	
FW-44PD-2	5	3/16	7,500	17.0	43/64	—	—	6.35	1/4	131	5 5/32	0.78	1.7	0.45	15.9	PT or NPT 1/4	6.3	1/4	
FW-44PD-20	5	3/16	7,500	17.0	43/64	—	—	6.35	1/4	131	5 5/32	0.78	1.7	0.45	15.9	PT or NPT 1/4	6.3	1/4	

The performance figures are at 0.63 MPa (6.3 bar).

⚠ Refer to "The Instructions and Warning for Safety Use" enclosed in each tool box.

FUJI AIR TOOLS CO., LTD.

2-1-14 Kamiji, Higashinariku, Osaka 537-0003, Japan

Tel : (06) 6972-2335

Fax : (06) 6972-2250

BOLT & NUT SETTERS
SCREW DRIVERS

ABRASIVE TOOLS

DRILLS • TAPPERS

PERCUSSION TOOLS

AIR MOTORS & OTHERS

OTHER PRODUCTS



PARTS LIST MODEL: FW-44P-2, -44PD-2, -20

EXPLODED VIEW

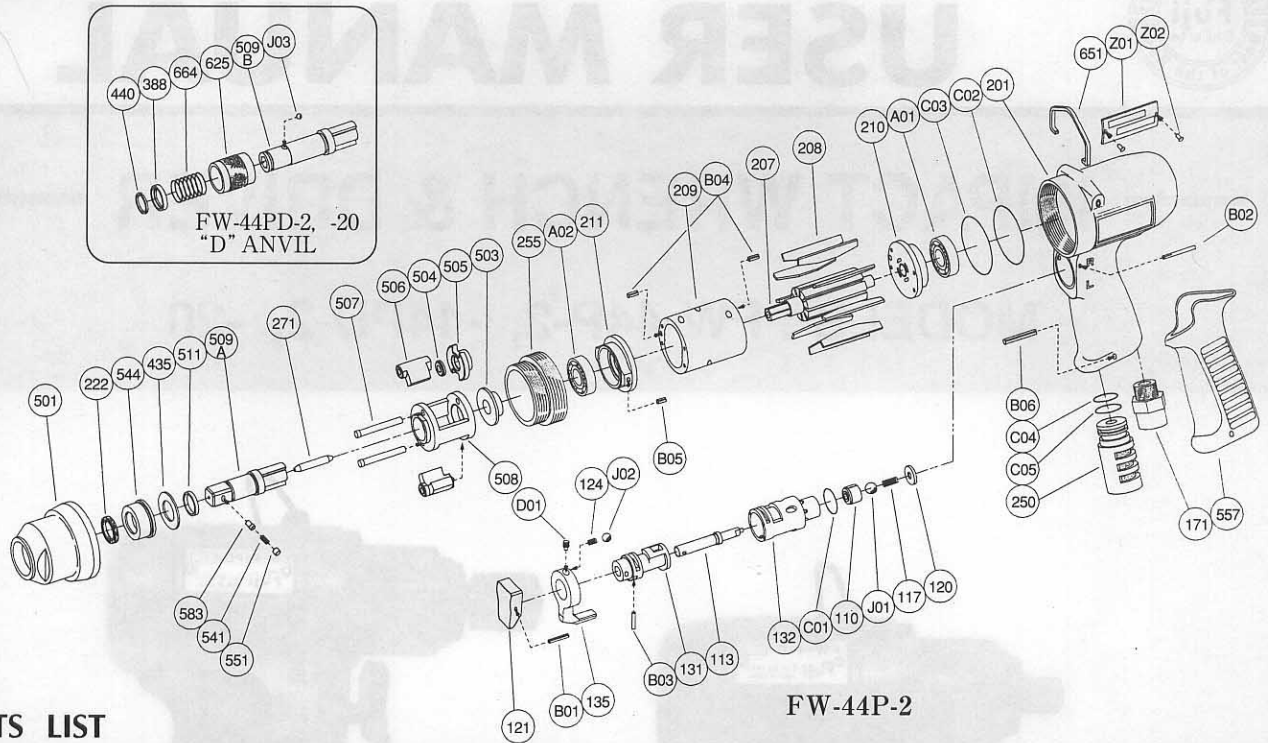

FW-44P-2

PARTS LIST

Index No.	Parts No.	Parts Name	Qt.	Index No.	Parts No.	Parts Name	Qt.
FW-44P-2				255	W-318255-00	Motor Fastening Nut	1
FW-44PD-2, -20				271	W-191271-00	Rotor Pin	1
CP No.	W-306006-01	Housing CP		435	W-306435-00	Thrust Washer	1
110	W-276110-01	Throttle Valve	1	503	W-306503-00	Spacer (B)	1
113	W-306113-00	Throttle Valve Rod	1	504	W-306504-00	Spacer (C)	1
117	W-276117-00	Throttle Valve Spring	1	505	W-306505-00	Cam	1
120	W-276120-01	Throttle Valve Cover	1	506	W-215506-01	Hammer Clutch	2
121	W-254121-00	Throttle Valve Lever	1	507	W-067507-00	Clutch Pin	2
124	W-254124-00	Knock Spring	1	508	W-215508-01	Clutch Frame	1
131	W-289131-00	Reverse Valve	1	509A	W-306509-03	Anvil (B)	1
132	W-306132-00	Reverse Valve Bushing	1	(541)	W-252541-00	Button Retainer Spring (F)	1
135	W-254135-00	Reverse Valve Lever	1	(551)	W-252551-00	Plug	1
171	W-276171-00	Inlet Bushing (PT)	1	(583)	W-252583-00	Retainer Button (F)	1
171	W-276171-01	Inlet Bushing (NPT)	1	511	W-215511-00	Clutch Frame Bushing	1
201	W-285201-01	Housing	1	557	W-276557-00	Rubber Protector	1
B01	SP-212	Spring Pin	1	651	W-225651-00	Hanger	1
B02	GP-220GLC	Grooved Pin	1	A01	BB-EE2	Ball Bearing	1
B03	NR-29.8	Needle Roller	1	A02	BB-EE3	Ball Bearing	1
C01	O-S15	"O" Ring	1	B06	SP-320	Spring Pin	1
D01	SS-46D	Set Screw	1	C02	O-S34	"O" Ring	1
J01	B-4U	Urethane Ball	1	C03	O-S34	"O" Ring	1
J02	B-3	Ball	1	C04	O-S14	"O" Ring	1
CP No.	W-306013-01	Clutch Housing CP		C05	O-S15	"O" Ring	1
222	W-306222-00	Felt Ring	1	Z01	NP-1100	Name Plate	1
501	W-318501-00	Clutch Housing	1	Z02	NPN-0×3.2	Screw Rivet	2
544	W-215544-01	Clutch Housing Bushing	1	FW-44PD-2, -20			
FW-44P-2				388	W-305388-00	Spring Holder	1
207	W-306207-00	Rotor	1	440	W-305440-00	Ring	1
208	W-289208-00	Rotor Blade	9	509B	W-306509-00	Anvil (D) (For FW-44PD-2)	1
209	W-289209-00	Cylinder	1	509B	W-306509-01	Anvil (D) (For FW-44PD-20)	1
(B04)	SP-2.56	Spring Pin	2	625	W-305625-00	Bit Cover	1
210	W-276210-01	Cylinder Upper Plate	1	664	W-305664-00	Finder Spring	1
211	W-289211-00	Cylinder Lower Plate	1	J03	B-3	Ball	1
(B05)	SP-2.55	Spring Pin	1	Z01	NP-1082	Name Plate	1
250	W-306250-00	Exhaust Cover	1				

□ CP No. denotes the assembled parts comprising of more than 1 pc. of parts.
The related parts are shown in the thick frame.

□ #209, 211 and 509A are supplied together with parts shown in ().
□ Specify parts number and quantity in ordering.