



USER MANUAL

IMPACT WRENCH

MODELS : FW-250P-1, -2



FW-250P-1
FW-250P-2

SPECIFICATIONS

Model	Capacity Bolt size (Guidance)		Rotational Frequency	Side to Center		Square Drive Size		Overall Length (without socket)		Mass (without socket)		Air Consumption (Under Load)		Air Inlet Thread Size		Air Hose Size	
	mm	in		mm	in	mm	in	mm	in	kg	lb	m ³ /min	ft ³ /min	in	mm	in	
FW-250P-1	24	1	5,000	36.5	1 7/16	25.4	1	228	8 31/32	5.3	11.7	0.7	24.7	PT or NPT 3/8	12.7	1/2	
FW-250P-2	24	1	5,000	36.5	1 7/16	19.0	3/4	226	8 29/32	5.3	11.7	0.7	24.7	PT or NPT 3/8	12.7	1/2	

The performance figures are at 0.63MPa (6.3bar).

⚠ Refer to "The Instructions and Warning for Safety Use" enclosed in each tool box.

FUJI AIR TOOLS CO., LTD.

2-1-14 Kamiji, Higashinari-ku, Osaka, 537-0003 Japan

Tel : (06) 6972-2335

Fax : (06) 6972-2250

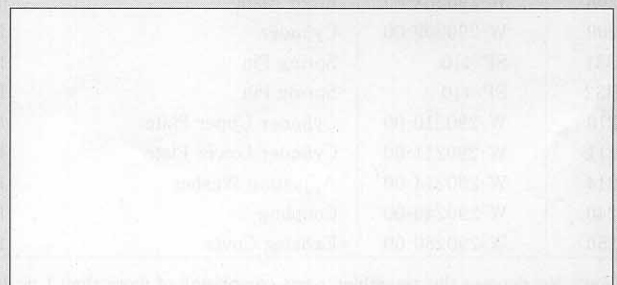

BOLT & NUT SETTERS
SCREW DRIVERS

ABRASIVE TOOLS

DRILLS • TAPPERS

PERCUSSION TOOLS

AIR MOTORS & OTHERS

OTHER PRODUCTS

PARTS LIST MODEL: FW-250P-1, -2

EXPLODED VIEW

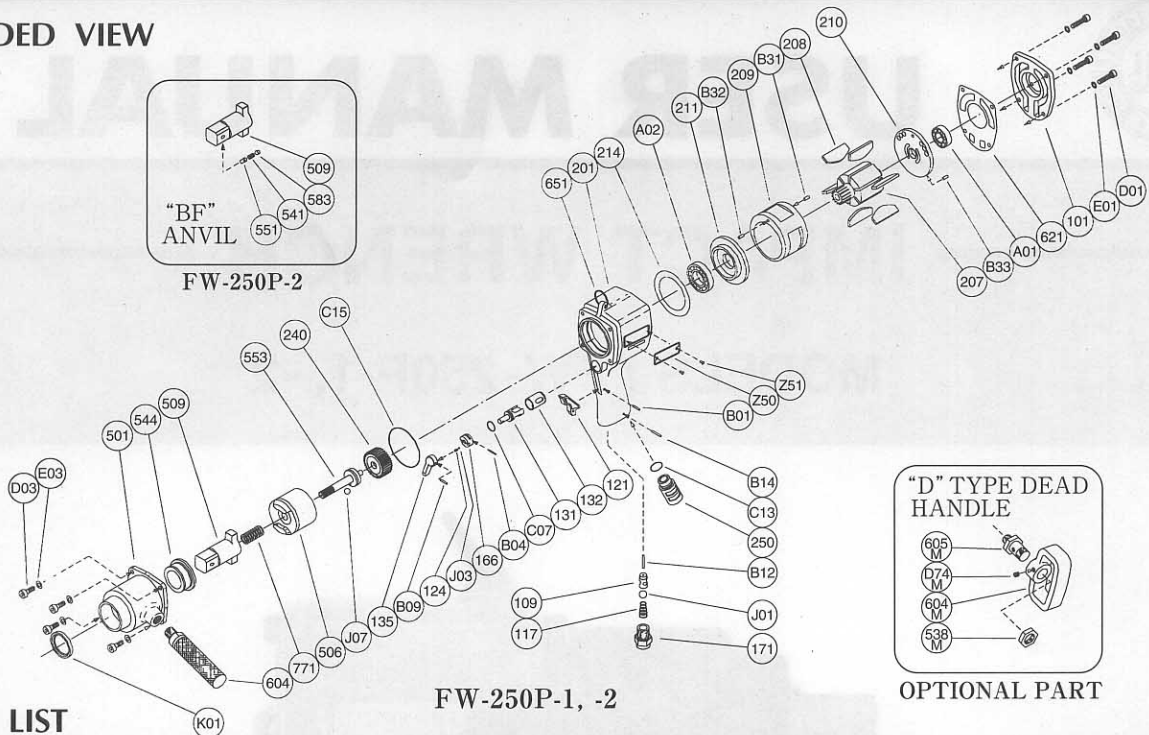

PARTS LIST

FW-250P-1, -2

OPTIONAL PART

Index No.	Parts No.	Parts Name	Qt.
FW-250P-1			
FW-250P-2			
Ass'y No.	W-290006-00	Housing Ass'y <PT>	
Ass'y No.	W-290006-01	Housing Ass'y <NPT>	
201	W-290006-50	Housing	1
109	W-290109-00	Throttle Valve Bushing	1
132	W-260132-00	Throttle Valve Bushing	1
117	W-290117-00	Throttle Valve Spring	1
121	W-252121-00	Throttle Valve Lever	1
124	G-005124-00	Knock Spring	1
131	W-260131-00	Reverse Valve	1
135	W-225135-00	Reverse Valve Lever	1
166	W-290166-00	Reverse Valve Cover	1
171	W-290171-00	Inlet Joint <PT>	1
	W-290171-01	Inlet Joint <NPT>	1
B01	SP-318	Spring Pin	1
B04	SP-225	Spring Pin	1
B09	SP-318	Spring Pin	1
B12	NR-326FR	Needle Roller	1
C07	O-S14	" O " Ring	1
J01	B-1/2	Ball	1
J03	B-3	Ball	1
Ass'y No.	W-290013-00	Clutch Housing Ass'y	
501	W-290501-00	Clutch Housing	1
544	W-290544-00	Clutch Housing Bushing	1
K01	OS-VB32455	Oil Seal	1
101	W-290101-00	Housing Cover	1
207	W-290207-00	Rotor	1
208	W-290208-00	Rotor Blade	6
209	W-290209-00	Cylinder	1
B31	SP-410	Spring Pin	1
B32	SP-410	Spring Pin	1
210	W-290210-00	Cylinder Upper Plate	1
211	W-290211-00	Cylinder Lower Plate	1
214	W-290214-00	Adjusting Washer	1
240	W-290240-00	Coupling	1
250	W-290250-00	Exhaust Cover	1

Index No.	Parts No.	Parts Name	Qt.
506	W-290506-00	Hammer Clutch	1
553	W-290553-00	Clutch Shaft	1
604	W-094604-00	Dead Handle	1
621	W-290621-00	Packing <A>	1
651	W-181651-00	Horizontal Hanger	1
771	W-290771-00	Spring	1
A01	BB-6003	Ball Bearing	1
A02	BB-EE9	Ball Bearing	1
B14	SP-326	Spring Pin	1
B33	SP-38	Spring Pin	1
C02	O-S70	" O " Ring	1
C13	O-S18	" O " Ring	1
D01	CS-620	Cap Screw	4
D03	CS-620	Cap Screw	4
E01	SW-6	Spring Washer	4
E03	SW-6	Spring Washer	4
J07	B-3/8	Ball	1
Z50	NP-3017	Name Plate	1
Z51	NPN-0×3.2	Screw Rivet	2
FW-250P-1			
509	W-290509-00	Anvil	1
FW-250P-2			
509	W-290509-01	Anvil	1
FW-250P-2			
"BF" ANVIL			
509	W-290509-02	Anvil 	1
(541)	W-192541-00	Button Retainer Spring <F>	1
(551)	W-192551-00	Plug	1
(583)	W-192583-00	Retainer Button <F>	1
OPTIONAL PART			
"D" TYPE DEAD HANDLE			
Ass'y No.	W-014014-00	"D" Type Dead Handle Ass'y	
538M	W-014538-M	Exllagon Nut 	1
604M	W-014604-M	Dead Handle	1
605M	W-014605-M	Dead Handle Joint	1
D74M	SS-810C	Set Screw <Cone Point>	1

Ass'y No. denotes the assembled parts comprising of more than 1 pc. of parts.
The related parts are shown in the thick frame.

#209, 211 and 509 are supplied together with parts shown in ().
 Specify parts number and quantity in ordering.