

FUJI



SCREW DRIVERS

These Screw Drivers are widely used for fastening and unfastening work of screws and nuts at a light electrical assembly line, an automobile assembly line, an aircraft industry. They are slip clutch types and the cam mechanism built in them is excellent, so you can operate them smoothly and easily. They all are reversible types and two handle types are available according to your applications and choice—straight lever and offset.

MODELS **FD-4** AND **FD-4P** SERIES
FD-5 AND **FD-5P** SERIES

CAPACITY (SCREW SIZE) : 4 MM (5/32") AND 5 MM (3/16")
ALL MODELS REVERSIBLE



FD-4



FD-5



FD-4P



FD-5P

LUBRICATION

After each two or three hours of operation, squirt a few drops of oil into the air inlet unless an air line lubricator is used. In case of FD-4P series and FD-5P series, they have an oil chamber, and please replenish the oil chamber with oil after each eight hours of operation.

SPECIFICATIONS

Model	Handle Type	Capacity (Screw Size)		Free Speed R.P.M.	Spindle Offset mm	Bit Shank Size		Overall Length		Weight kg	Air Inlet Thread Size P.T.	Air Hose Size	
		mm	in			mm	in	mm	in			mm	in
FD-4	Straight	4	5/32	2,000	18.5	6.35	1/4	174	6 7/8	0.8	1/4	6	1/4
FD-4-8	Straight	4	5/16	800	18.5	6.35	1/4	204	8 1/8	0.9	1/4	6	1/4
FD-4-10	Straight	4	3/8	400	18.5	6.35	1/4	232	9 1/8	1.0	1/4	6	1/4
FD-5	Straight	5	3/16	1,600	21.0	6.35	1/4	233	9 1/8	1.0	1/4	6	1/4
FD-5-8	Straight	5	7/16	900	21.0	6.35	1/4	243	9 5/8	1.3	1/4	6	1/4
FD-5-10	Straight	5	1/2	400	21.0	6.35	1/4	200	10 1/4	1.5	1/4	6	1/4
FD-4P	Offset	4	5/32	2,000	18.5	6.35	1/4	173	6 7/8	0.8	1/4	6	1/4
FD-4P-8	Offset	4	5/16	2,000	18.5	6.35	1/4	201	7 7/8	1.0	1/4	6	1/4
FD-4P-10	Offset	4	3/8	2,000	18.5	6.35	1/4	229	9 1/4	1.2	1/4	6	1/4
FD-5P	Offset	5	3/16	1,600	21.0	6.35	1/4	216	8 1/2	1.2	1/4	6	1/4
FD-5P-8	Offset	5	7/16	900	21.0	6.35	1/4	227	8 5/8	1.5	1/4	6	1/4
FD-5P-10	Offset	5	1/2	400	21.0	6.35	1/4	245	9 5/8	1.7	1/4	6	1/4

○ The recommended air pressure is 6 kg/cm² (85 lb/in²).

○ Standard Equipments: See the back page.

○ Specifications, standard equipments, designs and parts in this leaflet are subject to change without notice.

CAUTION: Handle with care to avoid dropping and bumping.

EXPLODED VIEW FOR FD-4, -5, -4P AND -5P

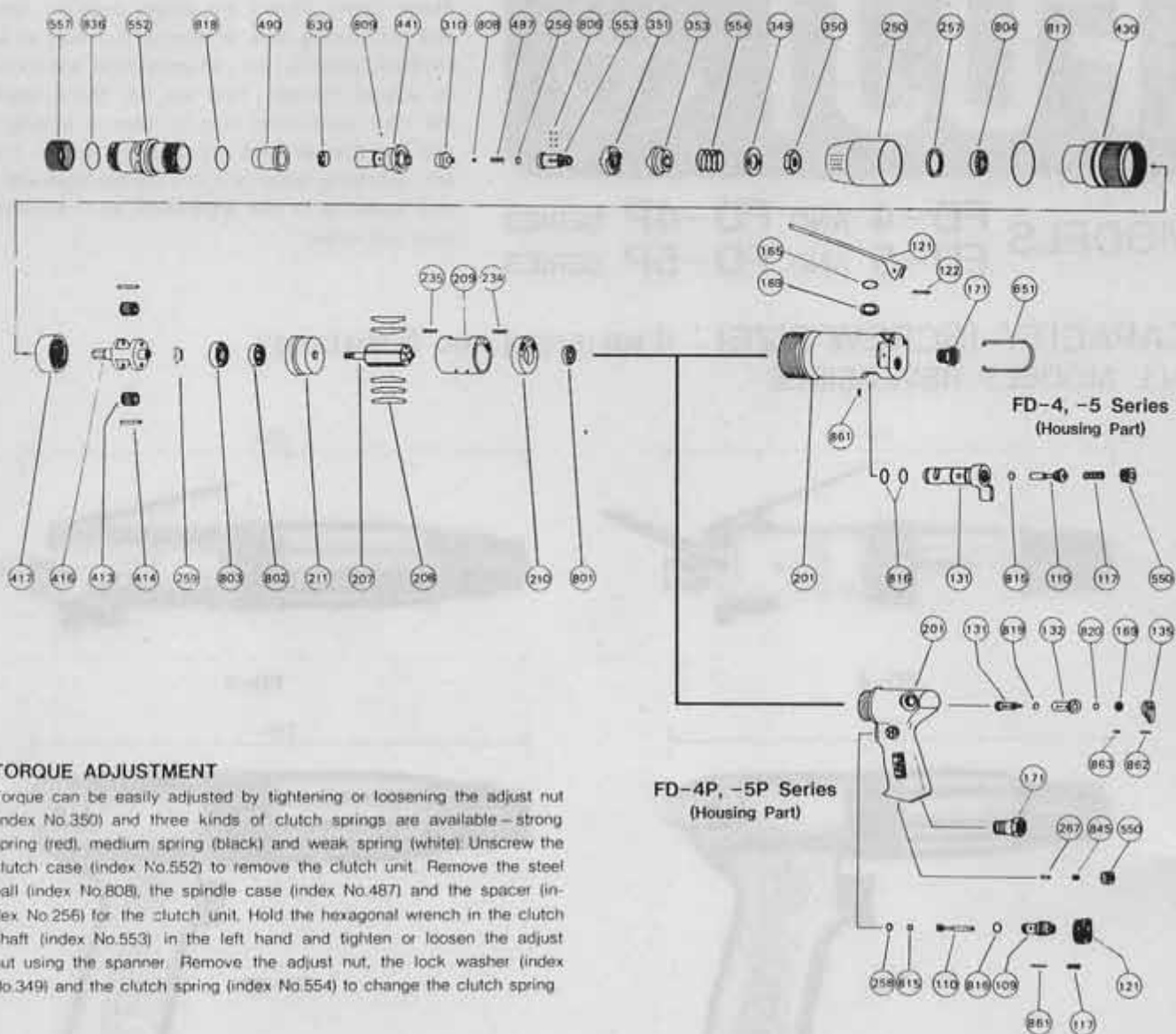

TORQUE ADJUSTMENT

Torque can be easily adjusted by tightening or loosening the adjust nut (index No.350) and three kinds of clutch springs are available—strong spring (red), medium spring (black) and weak spring (white). Unscrew the clutch case (index No.552) to remove the clutch unit. Remove the steel ball (index No.808), the spindle case (index No.487) and the spacer (index No.256) for the clutch unit. Hold the hexagonal wrench in the clutch shaft (index No.553) in the left hand and tighten or loosen the adjust nut using the spanner. Remove the adjust nut, the lock washer (index No.349) and the clutch spring (index No.554) to change the clutch spring.

PART LIST : FD-4, -5 SERIES

Index No.	Part No.		Part Name
	FD-5 Series	FD-4 Series	
CP No.	W-070006-00	W-075006-00	Housing CP
121	D-021121-A	G-028121-00	Throttle Valve Lever
122	SP-320	○	Spring Pin
165	SR-SA11	SR-SA13	Snap Ring
169	W-070169-01	W-075169-01	Reverse Valve Washer
171	IB-202000	IB-302080	Inlet Bushing
201	W-070201-00	W-075201-00	Housing
861	SP-25	○	Spring Pin
CP No.	W-070009-00	W-075009-00	Reverse Valve CP
110	W-070110-00	W-029110-A	Throttle Valve
117	W-025117-00	W-002117-00	Throttle Valve Spring
131	W-070131-01	W-075131-00	Reverse Valve
550	PL-1/8	○	Plug
815	O-S3	O-P3	"O" Ring
816	O-S10	O-S12	"O" Ring

- The letters CP in the Index No. column represent assembled parts. The parts which form CP are shown in the thick square line.
- The parenthesized part is supplied together when the part which is shown above the parenthesized part is ordered. The parenthesized part is available separately when it is ordered.
- The parenthesized figure in the Part Name column shows the number of required quantity.

Index No.	Part No.		Part Name
	FD-5P Series	FD-4P Series	
CP No.	W-071006-00	W-074006-00	Housing CP
109	W-025109-00	○	Throttle Valve Bushing
110	W-025110-A	○	Throttle Valve
117	W-025117-00	○	Throttle Valve Spring
121	W-025121-00	○	Trigger
131	W-071131-00	W-074131-00	Reverse Valve
132	W-071132-00	W-074132-00	Reverse Valve Bushing
135	W-074135-00	○	Reverse Valve Lever
169	W-071169-00	W-074169-00	Reverse Valve Washer
171	W-025171-00	○	Inlet Bushing
201	W-071201-00	W-074201-00	Housing
258	W-025258-00	○	Washer (C)
267	W-025267-00	○	Felt
550	PL-1/4	○	Plug
815	O-P3	○	"O" Ring
816	O-S9	○	"O" Ring
819	O-S8	O-P9	"O" Ring (2)
845	SS-56	○	Set Screw
861	SP-212	SP-214	Spring Pin
862	SP-212	○	Spring Pin
863	SP-26	○	Spring Pin

PART LIST : FD-4, -5 SERIES

Index No.	Part No.						Part Name
	FD-4 FD-4P	FD-4-8 FD-4P-8	FD-4-4 FD-4P-4	FD-5 FD-5P	FD-5-8 FD-5P-8	FD-5-4 FD-5P-4	
207	W-070207-00	○	○	W-100207-00	○	W-102207-00	Rotor
208	W-070208-00	○	○	W-100208-00	○	○	Rotor Blade (5)
209	W-070209-00	○	○	W-074209-00	○	○	Cylinder
234	SP-1.616	○	○	SP-1.616	○	○	Pin
235	SP-1.66	○	○	○	○	○	Pin
210	W-070210-00	○	○	W-074210-00	○	○	Cylinder Upper Plate
211	W-070211-00	○	○	W-074211-00	○	○	Cylinder Lower Plate
250	W-070250-00	W-073250-00	W-072250-00	W-074250-00	○	○	Exhaust Cover (Side)
250	W-070250-01	W-073250-01	W-072250-01	W-074250-01	○	○	Exhaust Cover (Front)
256	W-070256-00	○	W-074256-00	○	○	○	Spacer
257	W-070257-00	○	W-072257-00	W-074257-00	○	○	Washer
260			W-072260-00			W-083260-00	Bearing Case
310	W-070310-00	○	W-074310-00	○	○	○	Spindle Arbor
349	W-070349-00	○	W-074349-00	○	○	○	Lock Washer
350	W-070350-00	○	W-074350-00	○	○	○	Adjust Nut
351	W-070351-00	○	W-074351-00	○	○	○	Clutch
353	W-070353-00	○	W-074353-00	○	○	○	Slip Clutch
401		W-073401-00					No.1 Pinion
413	W-070413-00	W-073413-00	W-070413-00	D-001413-00	W-082413-00	W-083413-00	No.1 Planet Gear (2)
414	W-070414-00	○	○				No.1 Planet Gear Spindle (2)
414				NR-419	NR-331	NR-419	Needle Roller (30)
415				NR-110.5			Needle Roller (30)
416	W-070416-00	W-073416-00	W-072416-00	W-074416-00	W-082416-00	W-083416-00	No.1 Planet Gear Frame
417	W-070417-00	W-073417-00	W-070417-00	D-001417-00	W-082417-00	D-001417-00	No.1 Internal Gear
418		W-073418-00	D-023418-00			W-001418-00	No.2 Planet Gear (2)
419			D-021419-00				No.2 Planet Gear Spindle (2)
419		NR-315.8				NR-419	Needle Roller (2)
421		W-073421-00	W-072421-00			W-083421-00	No.2 Internal Gear
422		W-073417-00	W-070417-00			D-083417-00	Gear Case
430	W-070430-00	W-073430-00	W-072430-00	W-074430-00	W-082430-00	W-083430-00	Bearing Washer (2)
434		W-073434-00	W-072434-00				Thrust Washer (A)
435		W-073435-00	W-072435-00			W-083435-00	Spacer (A)
439					W-082308-00		Ring
440			W-074440-00	○	○	○	Spindle
441	W-070441-00	○	W-074441-00	○	○	○	Internal Gear Washer
444	W-070444-00	W-073444-00	W-070444-00				Thrust Washer (B) (4-4, 4P-4 (2))
480		W-072480-00	○				Main Spindle Spring
487	W-070487-00	○					Spindle Bushing
487			W-002117-00	○	○	○	Plug
490	W-070490-00	○	W-074490-00	○	○	○	Clutch Case
551			W-074551-00	○	○	○	Clutch Shaft
552	W-070552-00	○	W-074552-00	○	○	○	Clutch Spring (Weak)
553	W-070553-00	○	W-074553-00	○	○	○	Clutch Spring (Medium)
554	W-070554-B	○	W-074554-B	○	○	○	Clutch Spring (Strong)
557	W-070557-00	○	○	○	○	○	Protector
630	W-070630-00	○	○	○	○	○	Driver Chuck Ball Ring
651	W-070651-00	○	○	G-028651-00	○	○	Hanger (Horizontal)
801	BB-634	○	○	BB-626	○	○	Ball Bearing
802	BB-626	○	○	BB-608	○	○	Ball Bearing
803	BB-EE3	○	○	BB-EE4	○	○	Ball Bearing
804	BB-EE3	BB-6200	BB-6000	BB-EE4	○	BB-6001	Ball Bearing
805		BB-EE3	○			BB-EE4	Ball Bearing
806	B-1/8	○	B-4	○	○	○	Steel Ball (6)
807			B-1/8	○	○	○	Steel Ball (15)
808	B-5	○	B-8	○	○	○	Steel Ball
809	B-1/8	○	○	○	○	○	Steel Ball
817	O-S32	O-S34	○	O-S36	○	○	"O" Ring
818	O-S26	○	O-S32	○	○	○	"O" Ring
836	O-S18	○	○	○	○	○	"O" Ring
864				SP-26			Spring Pin (2)
PARTS NECESSARY FOR USE OF SLOTTED HEAD BITS (OPTION)							
661	W-070661-02	○	○	W-074661-02	○	○	Finder (for 2" long Bit)
661	W-070661-03	○	○	W-074661-03	○	○	Finder (for 3" long Bit)
661	W-070661-04	○	○	W-074661-04	○	○	Finder (for 4" long Bit)
661	W-070661-06	○	○	W-074661-06	○	○	Finder (for 6" long Bit)
663	W-070663-00	○	○	○	○	○	Finder Guide
664	W-070664-00	○	○	○	○	○	Finder Spring

SECTIONAL VIEWS

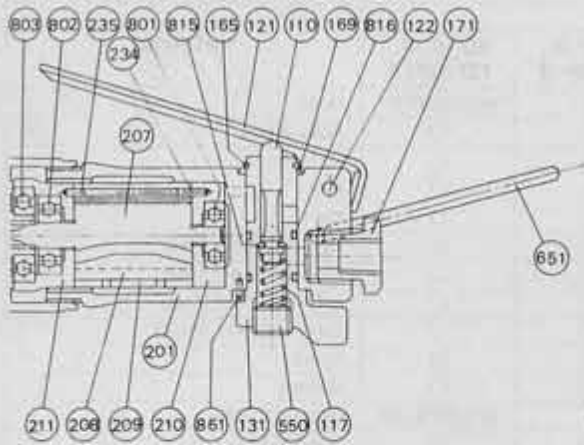

**HANDLE AND MOTOR PART
FOR FD-4 SERIES**

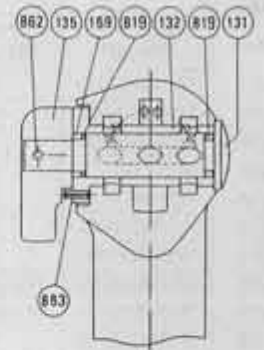
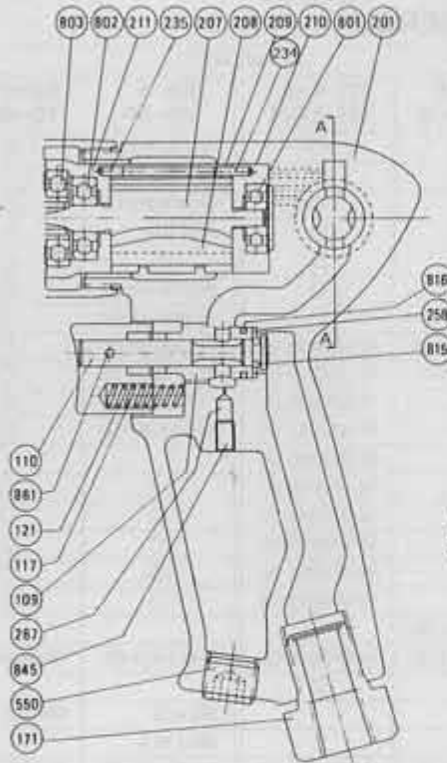

A-A SECTION

**HANDLE AND MOTOR PART
FOR FD-4P SERIES**

Parts necessary for use
of Slotted Head Bits

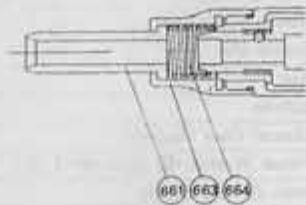

FOR FD-4 AND FD-4P

**GEAR AND CLUTCH PART
FOR FD-4 AND FD-4P**

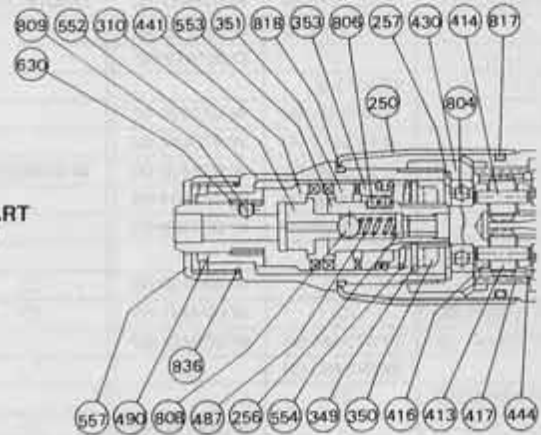

FOR FD-4-8 AND FD-4P-8

**GEAR AND CLUTCH PART
FOR FD-4-8 AND FD-4P-8**

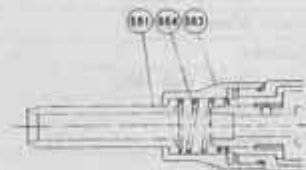

FOR FD-4-4 AND FD-4P-4

**GEAR AND CLUTCH PART
FOR FD-4-4 AND FD-4P-4**

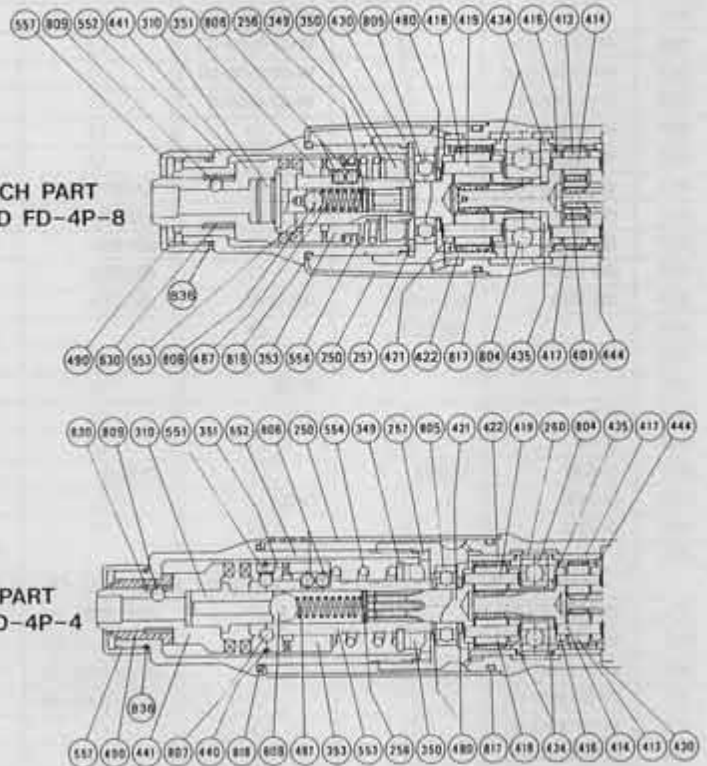

SECTIONAL VIEWS

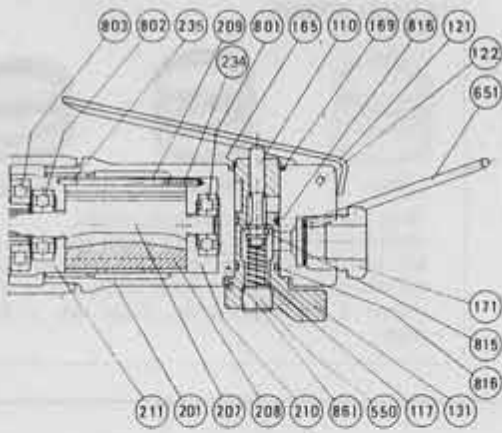

**HANDLE AND MOTOR PART
FOR FD-5 SERIES**

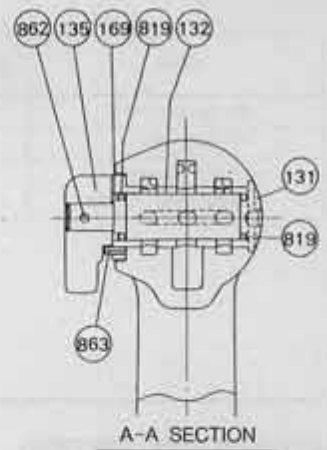
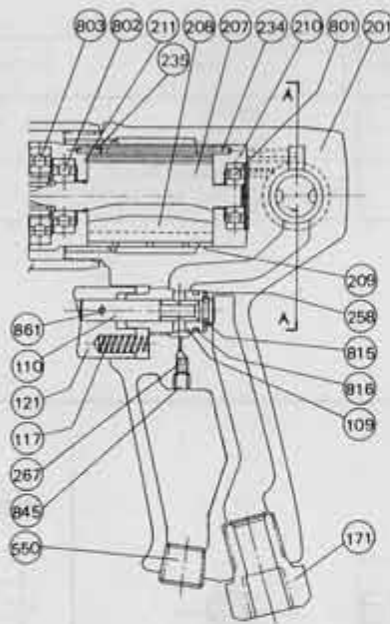

**HANDLE AND MOTOR PART
FOR FD-5P SERIES**

Parts necessary for use
of Slotted Head Bits

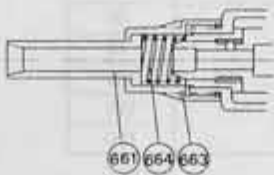

FOR FD-5 AND FD-5P

**GEAR AND CLUTCH PART
FOR FD-5 AND FD-5P**

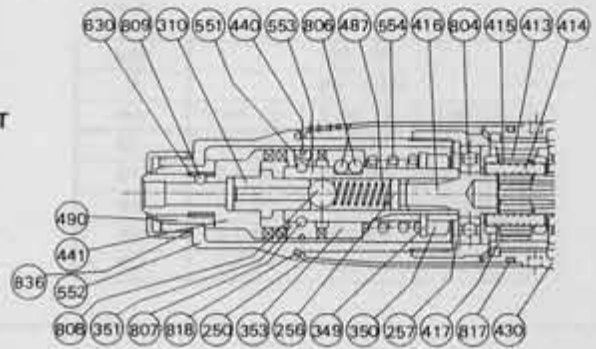

FOR FD-5-8 AND FD-5P-8

**GEAR AND CLUTCH PART
FOR FD-5-8 AND FD-5P-8**

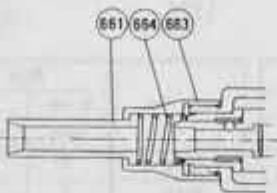

FOR FD-5-4 AND FD-5P-4

**GEAR AND CLUTCH PART
FOR FD-5-4 AND FD-5P-4**

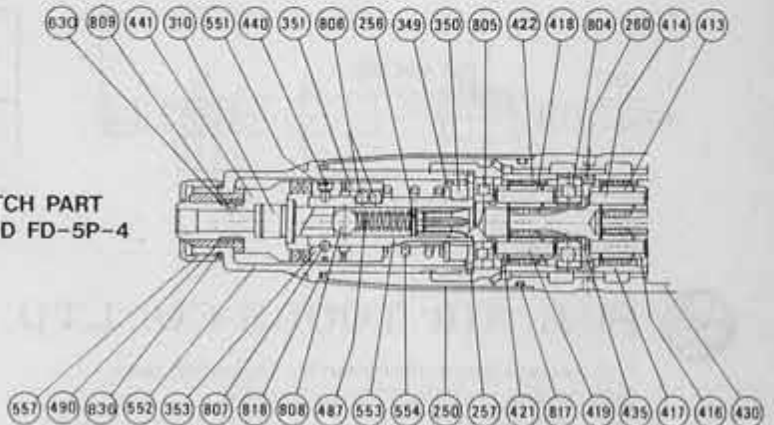
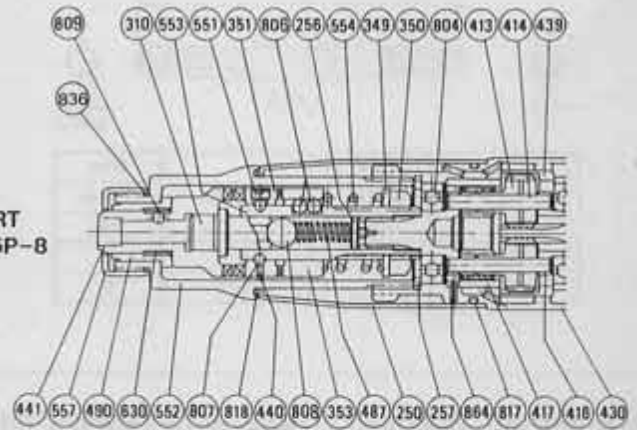

STANDARD EQUIPMENTS :

Name	Pieces	Name	Pieces
Air Supply Hose	1	Spanner	2
Air Regulator	1	Hook Spanner	1
Clutch Spring (Weak and Strong)	2	BIT (Phillips Head)	1
		Hex. Pin Wrench	1

CLUTCH SPRING



Weak



Medium



Strong

There are three kinds of clutch springs. Medium spring (black) is built in the screw driver and weak spring (white) and strong spring (red) are provided as standard equipments. As to the change of the clutch spring, please refer to the page.

ACCESSORIES (OPTION)

BITS (PHILLIPS HEAD)

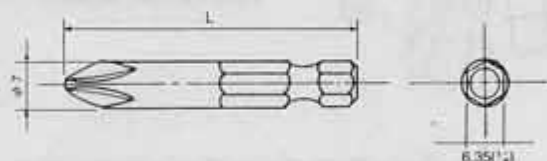

AC No.			Size
Head No.			L
⊕ No.1	⊕ No.2	⊕ No.3	mm
PB-1-2	PB-2-2	PB-3-2	50
PB-1-3	PB-2-3	PB-3-3	75
PB-1-4	PB-2-4	PB-3-4	100
PB-1-5	PB-2-5	PB-3-5	125
PB-1-6	PB-2-6	PB-3-6	150

BITS (SLOTTED HEAD)

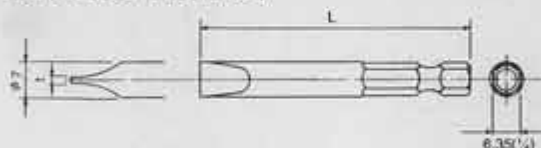

AC No.	Size	
	t	L
	mm	mm
SB-0.7	0.7	56
SB-0.9-2	0.9	50
SB-0.9-3		75
SB-0.9-4		100
SB-0.9-5		125
SB-0.9-6		150

ALLEN BITS

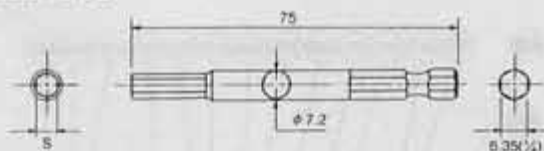

AC No.	Size		AC No.	Size	
	S Hex	D		S Hex	D
	mm			mm	
HH-3	3		HH-5	5	
HH-4	4		HH-6	6	

SOCKET HEAD BITS

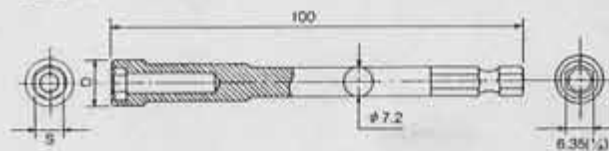

AC No.	Size		AC No.	Size	
	S Hex	D		S Hex	D
	mm			mm	
SH-5	5	8	SH-8	8	12
SH-6	6	10	SH-9	9	13
SH-7	7	11	SH-10	10	15

BITS AND BIT HOLDERS (THESE ACCESSORIES ARE TO BE USED AS A PAIR.)

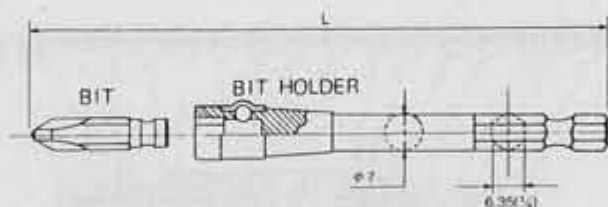

BITS

AC No.	Head No.	Bit Hex Size	Bit Length
		mm	mm
DBH-1	⊕ No.1	5	25
DBH-2	⊕ No.2		
DBH-3	⊕ No.3		

BIT HOLDERS

AC No.	Size
	L
	mm
BH-56	56
BH-75	75
BH-100	100
BH-125	125



FUJI AIR TOOLS CO., LTD.

1-14, Kamiji 2-chome, Higashinari-ku, Osaka, 537 Japan
 Cable Address: "FUJI AIR TOOLS" OSAKA
 Telex: 5298510 FUJIAT J
 Telefax: (06) 972-2250
 Telephone: (06) 972-2335 (Overseas Dept)
 (06) 972-2331 (Key Number)